



# SERVICE BOOK

MOUNTING INSTRUCTION OF CONNECTORS



SERVICE MOUNTING INSTRUCTION ASPÖCK SYSTEMS SERVICE MOUNTING INSTRUCTION ASPÖCK SYSTEMS SERVICE MOUNTING INSTRUCTION ASPÖCK SYSTEMS



## List of contents

|                            |        | Page |
|----------------------------|--------|------|
| Symbol legend              |        | 4    |
| DC-System (double click)   |        | 10   |
| P&R-System (press & ready) |        | 12   |
| Bayonet                    | 2 pin  | 14   |
|                            | 5 pin  | 18   |
|                            | 8 pin  | 22   |
|                            | 15 pin | 28   |
| ASS1, ASS2                 | 2 pin  | 32   |
| ASS1, ASS2, ASS2.1         | 7 pin  | 36   |
| ASS3                       | 3 pin  | 40   |
|                            | 17 pin | 44   |
| AMP                        | 4 pin  | 48   |
|                            | 7 pin  | 52   |
| SuperSeal                  | 2 pin  | 56   |
|                            | 3 pin  | 60   |
|                            | 4 pin  | 64   |
|                            | 6 pin  | 68   |
| DEUTSCH connector          | 2 pin  | 72   |
|                            | 4 pin  | 76   |
|                            | 6 pin  | 80   |
| Standard connector         | 8 pin  | 82   |
|                            | 12 pin | 82   |
| Caravan connector          | 16 pin | 84   |
| ISO 1185                   | 7 pin  | 85   |
| ISO 3731                   | 7 pin  | 85   |
| ISO 12098                  | 13 pin | 86   |
|                            | 15 pin | 87   |
| ISO 1724                   | 7 pin  | 88   |
| ISO 11446                  | 8 pin  | 89   |
|                            | 13 pin | 89   |
| DIN 9680                   | 3 pin  | 90   |
| VBG                        | 14 pin | 91   |

| Symbol |                          |                             |                               |  |   |
|--------|--------------------------|-----------------------------|-------------------------------|--|---|
|        | Masse                    | Earth                       | massa                         | Masse                                  | Masa  |
|        | Blinker links            | LH rear direction indicator | freccia sinistra              | Clignotant gauche                      | Intermitente izquierdo                          |
|        | Blinker rechts           | RH rear direction indicator | freccia destra                | Clignotant droit                       | Intermitente derecho                            |
|        | Bremslicht               | stop                        | stop                          | Feu stop                               | Luz de freno                                    |
|        | Standlicht links         | LH Tail                     | posizione sinistra            | Feu de position gauche                 | Luz posición izquierda                          |
|        | Standlicht rechts        | RH Tail                     | posizione destra              | Feu de position droit                  | Luz posición derecha                            |
|        | Nebelschlussleuchte      | rear fog                    | retronebbia                   | Feu de brouillard                      | Luz antiniebla                                  |
|        | Rückfahrleuchte          | reverse                     | retromarcia                   | Feu de recul                           | Luz marcha atrás                                |
|        | All. Stromversorgung (+) | permanent power supply      | positivo permanente           | Alimentation électrique permanente (+) | corriente continua                              |
|        | Achsanhhebung            | axle lift                   | Sollevatore                   | Relevage d'essieu                      | dispositivo de elevación del eje                |
|        | Federspeicheranzeige     | braking control             | Controllo funzionamento freni | Contrôle freinage remorque             | Control de frenos para trailers                 |
|        | Verschleißanzeige        | brake pad wear Indicator    | Controllo usura pastiglie     | Témoin d'usure des plaquettes de frein | Indicador de desgaste de las pastillas de freno |
|        | Masse für Elektroniken   | Earth - Data                | Massa per elettronica         | Masse des éléments électroniques       | masa funciones electrónicas                     |
|        | freie Wahl               | unallocated                 | libero                        | Libre                                  | Libre elección                                  |

|   |                            |                        |                         |                             | Symbol |
|---|----------------------------|------------------------|-------------------------|-----------------------------|--------|
| Terra                                       | Massa                      | Jord                   | jord                    | maa                         |        |
| Pisca esquerdo                              | knipperlicht Links         | Venstre blinklys       | blinker vänster         | vilkku vasen                |        |
| Pisca direito                               | knipperlicht Rechts        | Høyre blinklys         | blinker höger           | vilkku oikea                |        |
| Freio                                       | Rem licht                  | Bremselys              | bromslyus               | jarruvalo                   |        |
| Luz de posição esquerda                     | Achterlamp Links           | Venstre parklys        | parklyus vänster        | parkki vasen                |        |
| Luz de posição direita                      | Achterlamp Rechts          | Høyre parklys          | parklyus höger          | parkki oikea                |        |
| Luz de neblina                              | Mist lamp                  | Tåkelys                | dimlyus                 | sumuvalo                    |        |
| Luz de Ré                                   | Achteruitrij lamp          | Baklys                 | backlyus                | peruutusvalo                |        |
| corrente contínua                           | Constante stroomverzorging | Allmenn strømforsyning | allmän strömförsörjning | jatkuva virta               |        |
| dispositivo de elevação do eixo             | Aslift                     | Akselløft              | axellyft                | akselinosto                 |        |
| Controle de funcionamento dos freios        | Remcilinder markering      | Bremseindikator        | bromsindikator          | jousijarrun ilmaisin        |        |
| Indicador de desgaste de pastilhas de freio | Remslijtage indicator      | Slitasjeindikator      | slitageindikator        | jarrujen kulumisen ilmaisin |        |
| Terra para funções electrónicas             | Massa Data                 | Jord for elektronikk   | jord för elektronik     | elektroniikan maa           |        |
| Livre                                       | Vrije positie              | Fritt valg             | fritt val               | vapaa                       |        |

| Symbol |                                    |                         |                                       |                                 |                                 |
|--------|------------------------------------|-------------------------|---------------------------------------|---------------------------------|---------------------------------|
|        | Mass                               | Masa                    | Masa                                  | маса                            | масса                           |
|        | Vasak suunatuli                    | Kreisais pagrieziens    | Lewy Kierunkowskaz                    | лівий поворотник                | левый поворотник                |
|        | Parem suunatuli                    | Labais pagrieziens      | Prawy Kierunkowskaz                   | правий поворотник               | правый поворотник               |
|        | Pidurituli                         | Stop signāls            | Światło Stop                          | стоп-сигнал                     | стоп-сигнал                     |
|        | Vasak tagatuli                     | Kreisais gabarīts       | Lewa Pozycja                          | ліве габаритне світло           | левый габаритный свет           |
|        | Parem tagatuli                     | Labais gabarīts         | Prawa Pozycja                         | праве габаритне світло          | правый габаритный свет          |
|        | Udutuli                            | Miglas lukturis         | Światło Przeciwmgłowe                 | проти́во- туманний лі́тар       | проти́во-туманный фонарь        |
|        | Tagurdustuli                       | Atpakaļgaitas lukturis  | Światło Cofania                       | лі́тар заднього ходу            | фонарь заднего хода             |
|        | Pidev toide                        | Pastāvīgs spriegums     | Stale Zasilanie                       | постійна напруга                | постоянное напряжение питания   |
|        | Telje tõste                        | Paceļamais tiits        | Podnoszenie Osi                       | підйомна вісь                   | подъёмная ось                   |
|        | Pidurduskontroll                   | Bremžu kontrole         | Kontrola Hamowania                    | керування гальмуванням          | управление торможением          |
|        | Piduriklotside kulumise indikaator | Bremžu nodiluma sensors | Wskaźnik Zużycia Okładzin Hamulcowych | датчик зносу гальмівних колодок | датчик износа тормозных колодок |
|        | Infokaabli mass                    | Masa- Dati              | Masa Elektroniki                      | маса електроніки                | масса электроники               |
|        | Vaba                               | Brīvais                 | Wolny                                 | вільний                         | свободный                       |

|                        |                         |                    |                           |                             | Symbol |
|------------------------|-------------------------|--------------------|---------------------------|-----------------------------|--------|
| Uzemnění               | Uzemnenie               | Földelés           | masa, ozemljitev          | Masa, uzemljenje            |        |
| Blinkr levá strana     | Smerovka lavá strana    | Index, bal         | smerokaz levi             | Lijevi žmigavac             |        |
| Blinkr pravá strana    | Smerovka pravá strana   | Index, jobb        | smerokaz desni            | Desni žmigavac              |        |
| Brzdové světlo         | Brzdové svetlo          | Féklámpa           | stop luč                  | Štop svijetlo               |        |
| Parkovací světlo levé  | Parkovacie svetlo lavé  | Helyzetjelző, bal  | leva pozicijska luč       | Lijevo poziciono svijetlo   |        |
| Parkovací světlo pravé | Parkovacie svetlo pravé | Helyzetjelző, jobb | desna pozicijska luč      | Desno poziciono svijetlo    |        |
| Mihovka                | Hmlové svetlo           | Ködlámpa           | meglenka                  | Maglenka                    |        |
| Zpáteční světlo        | Svetlo spiatocky        | Tolatólámpa        | luč vzvratne vožnje       | Rikverc svijetlo            |        |
| Stálý elektrický proud | Stály elektrický prúd   | Töltés             | napajanje                 | Napajanje                   |        |
| Zdvihnutí nápravy      | Zdvihnutie nápravy      | Tengelyemelés      | dvig osi                  | Podizač osovine             |        |
| Kontrola brzdy         | Kontrola brzdy          | Fékvisszajelző     | kontrola zavor            | Kontrola kočnica            |        |
| Indikátor opotřebení   | Indikátor opotrebenia   | Fékkopás jelző     | indikator obrabe zavor    | Indikator potrošnje kočnica |        |
| Uzemnění elektroniky   | Uzemnenie elektroniky   | Elektr. Földelés   | ozemljitev za elektroniko | Uzemljenje za elektroniku   |        |
| Volné                  | Volné                   | Szabad             | odklijenjeno              | Otključano                  |        |

| Symbol |                             |                             |                                 |                         |
|--------|-----------------------------|-----------------------------|---------------------------------|-------------------------|
|        | Masa, uzemljenje            | Masa, uzemljenje            | Masa (impamintare)              | заземление              |
|        | Lijevi žmigavac             | Levi žmigavac               | indicator semnalizare stanga    | ляв мигач               |
|        | Desni žmigavac              | Desni žmigavac              | indicator semnalizare dreapta   | десен мигач             |
|        | Štop svijetlo               | Štop svetlo                 | STOP                            | стоп сигнал             |
|        | Lijevo poziciono svijetlo   | Levo poziciono svetlo       | lampa pozitie stanga            | габарит лев             |
|        | Desno poziciono svijetlo    | Desno poziciono svetlo      | lampa pozitie dreapta           | габарит десен           |
|        | Maglenka                    | Maglenka                    | lampa ceata                     | светлина задна за мъгла |
|        | Rikverc svijetlo            | Rikverc svetlo              | lampa marsarier                 | светлини задна скорост  |
|        | Napajanje                   | Napajanje                   | Alimentare electrica permanenta | постоянно напряжение    |
|        | Podizač osovine             | Podizač osovine             | axa liftanta                    | повдигане оси           |
|        | Kontrola kočnica            | Kontrola kočnica            | control sistem franare          | ръчна спирачка          |
|        | Indikator potrošnje kočnica | Indikator potrošnje kočnica | Indicator uzura placate frana   | износване на накладките |
|        | Uzemljenje za elektroniku   | Uzemljenje za elektroniku   | Masa                            | електроника заземление  |
|        | Otključano                  | Otključano                  | Liber                           | свободно                |

| Symbol |                  |                     |                               |                       | Symbol |
|--------|------------------|---------------------|-------------------------------|-----------------------|--------|
|        | Şase, toprak     | ترا                 | يضرال                         | הקראה                 |        |
|        | Sinyal, sol      | پچ اینهار           | ماجتال يغلخلا رشؤملا نيميلدا  | לאמש תותיא            |        |
|        | Sinyal, sağ      | تسار اینهار         | ماجتال يغلخلا رشؤملا راسيلا   | ימי תותיא             |        |
|        | Fren             | زمرت غارچ           | فقتوت                         | סלב רוא               |        |
|        | Park, sol        | پچ فقتوت غارچ       | راسيلا ليذلا عوض              | לאמש הינח             |        |
|        | Park, sağ        | تسار فقتوت غارچ     | نيميلدا ليذلا عوض             | ימי הינח              |        |
|        | Arka sis         | بيق نكش هم غارچ     | يغلخلا بابضلا لييزم           | לפרע רוא              |        |
|        | Geri vites       | بيق هندن غارچ       | فغلا يلا ريسملا تراشا         | סרוור/רוחאל העיסנ רוא |        |
|        | Sürekli enerji   | يمیاد هیذغت عینم    | ٤٤٢٤٤ - میاد قاطلا تادادما    | העובק הנזה            |        |
|        | Dingil kaldırma  | روحم ربالاب         | روحملا عفر                    | ורס תמרה יוויח        |        |
|        | Treyler EBS      | زمرت لرتنك          | فوقولاب مكحيتلا تراشا         | הינח סלב יוויח        |        |
|        | Balata aşınma    | تنل شيسرگناشن       | حبالوكلا هي حالص امتنلا تراشا | הדיפור יאלב יוויח     |        |
|        | Şase, elektronik | لكينورتكلل يارب ترا | يضرال تانايب                  | הקינورتקלא הקראה      |        |
|        | Serbest hat      | دازآ باخشتن         | هرح/طبرلا مدع ؤلاح            | ינפ                   |        |

DC  
System

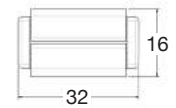

I<sub>max</sub>=5A

IP69K

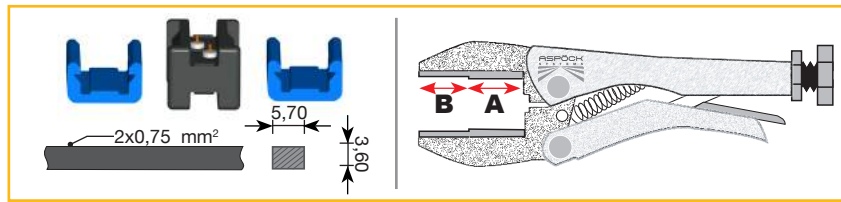

1.



2.

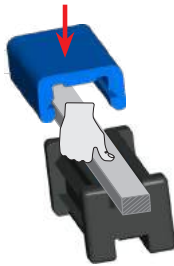

3.

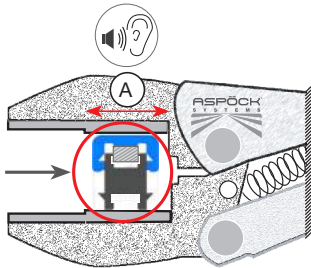

4.

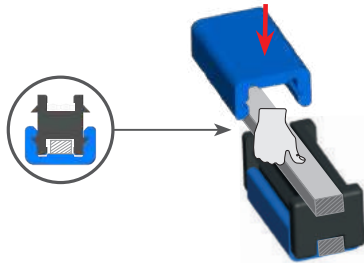

5.

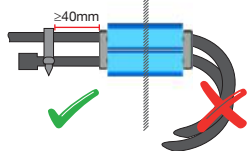
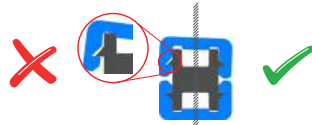
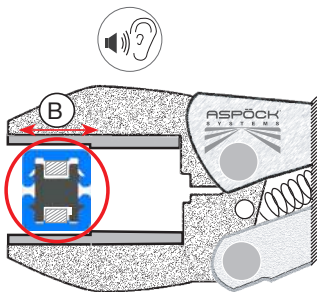

DC  
System

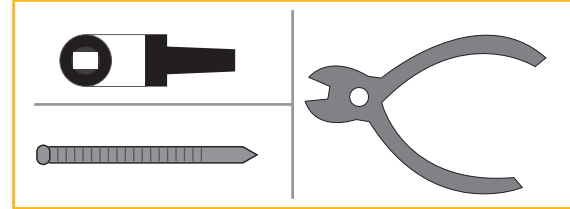
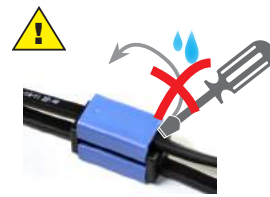

1.

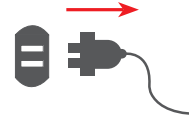

2.

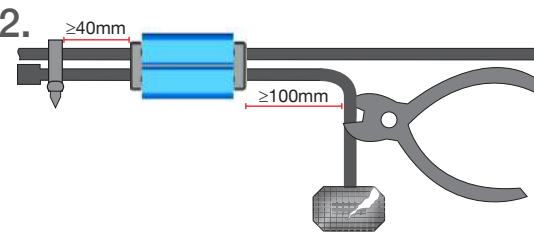

3.

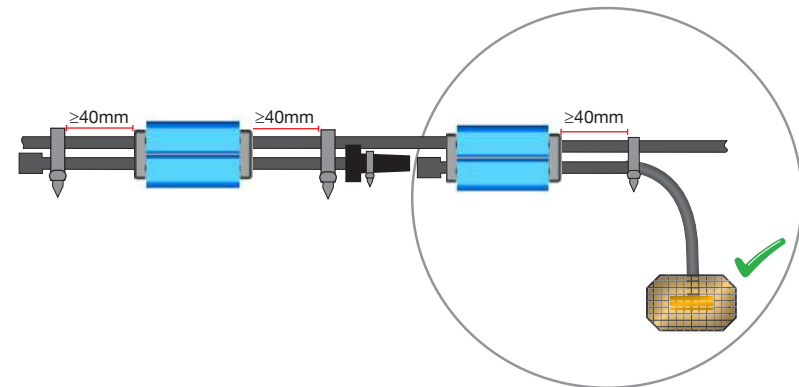
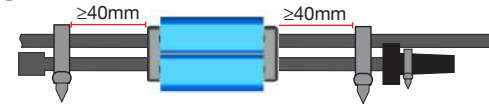

Watch the  
mounting  
video online!



P&R  
System

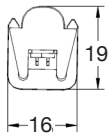
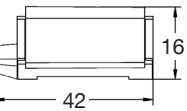

Imax=8A

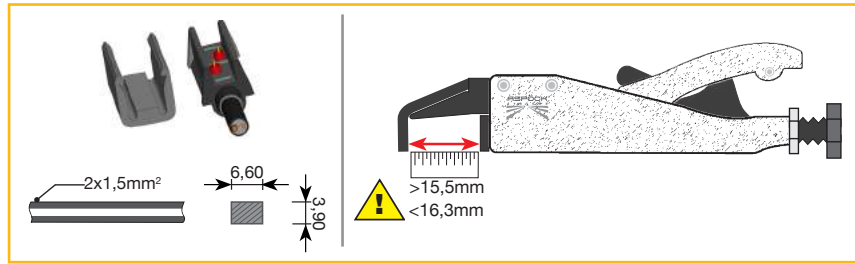

1.



2.



3.

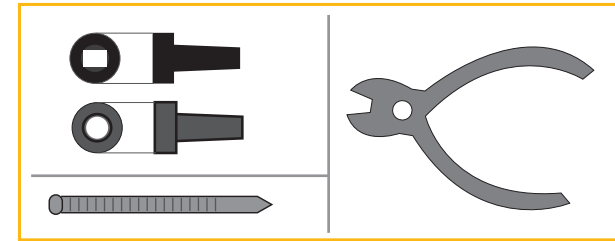
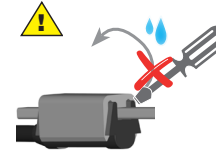
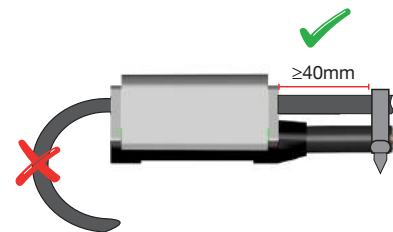
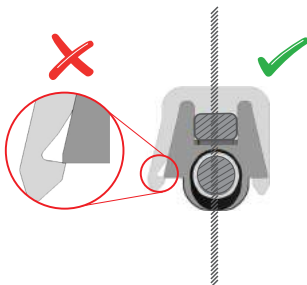
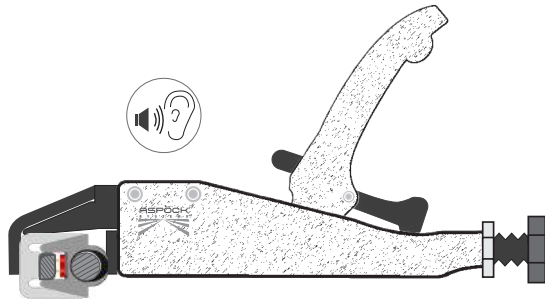

1.

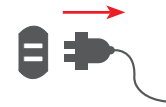

2.

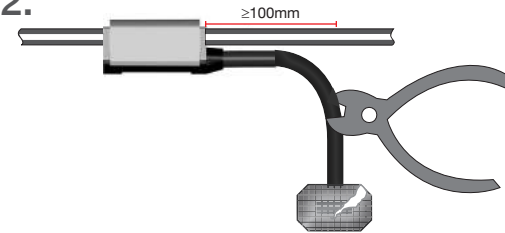

3.

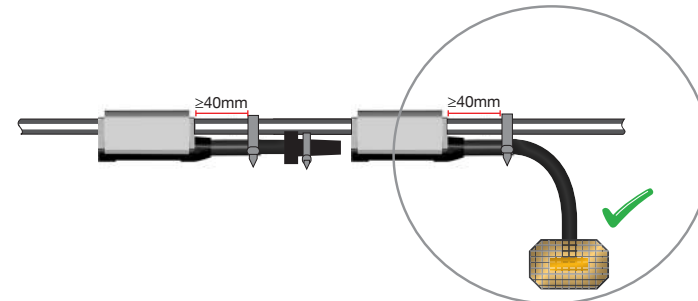
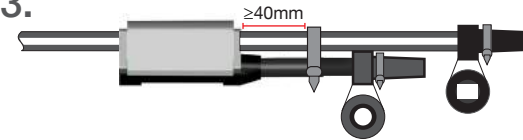

P&R  
System

Watch the  
repair video  
online!



Watch the  
mounting  
video online!





Bayonet 2 pin



SPARE PART NO.: 13-0246-004

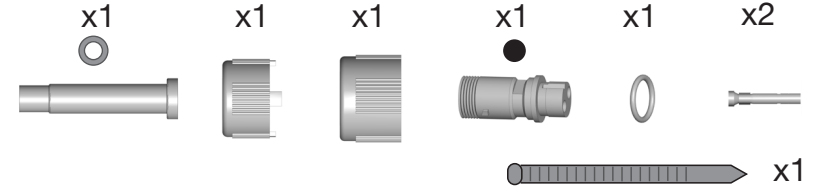

Bayonet 2 pin

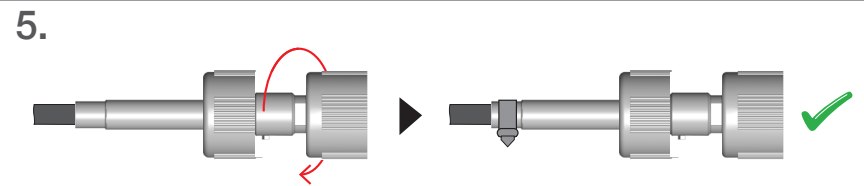
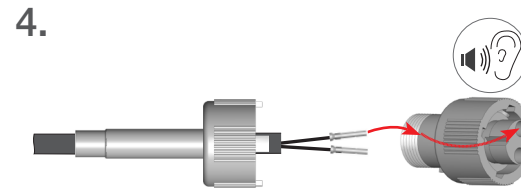
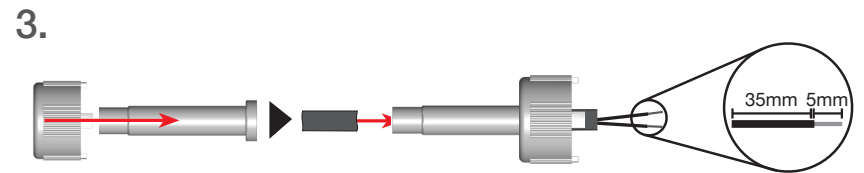
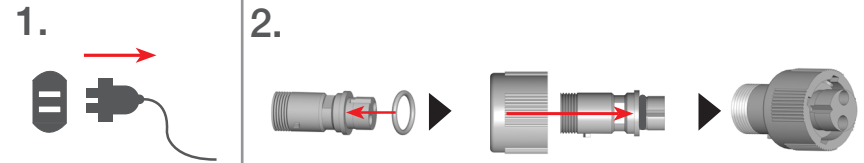
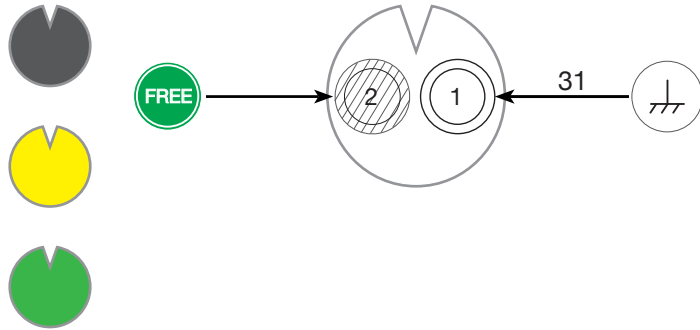
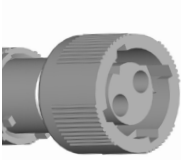
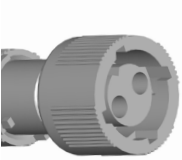

Imax=16A



Imax=16A





Bayonet  
2 pin



SPARE PART NO.: 13-0236-004

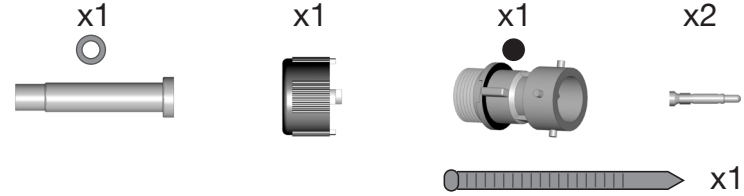

Bayonet  
2 pin

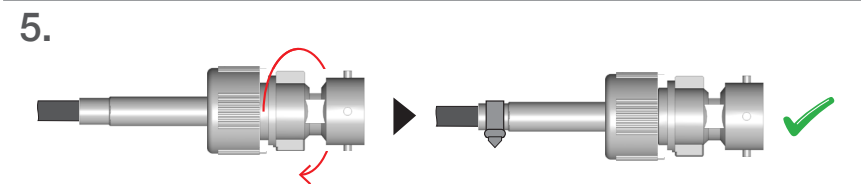
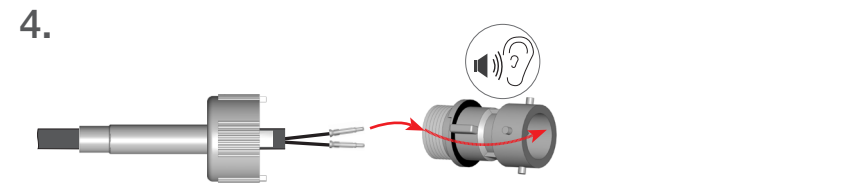
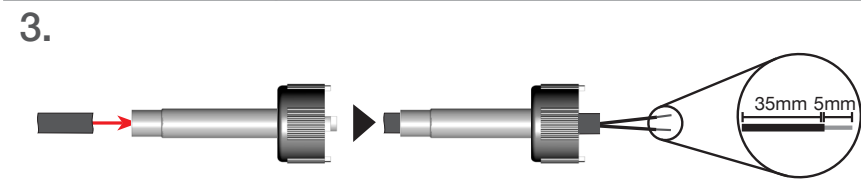
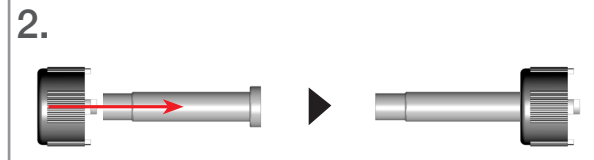
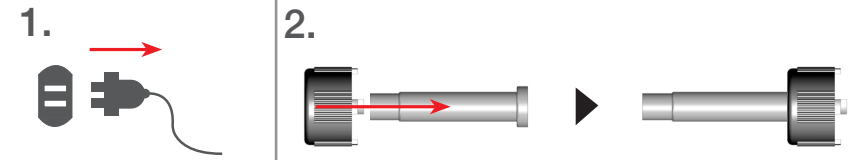
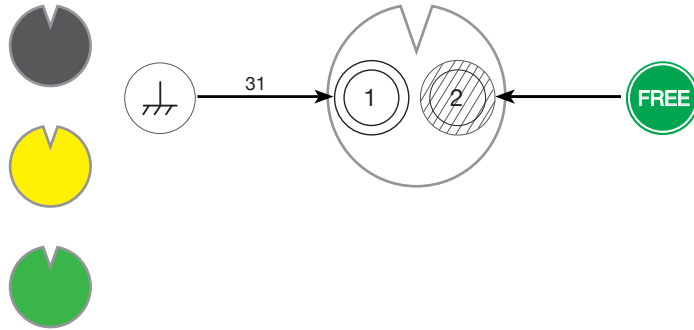
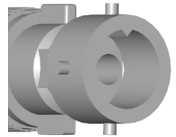
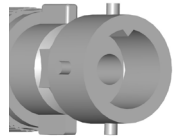

Imax=16A



Imax=16A



Bayonet 5 pin



SPARE PART NO.: 13-0521-104

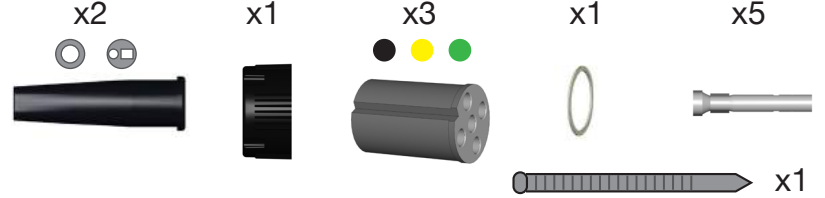

Bayonet 5 pin

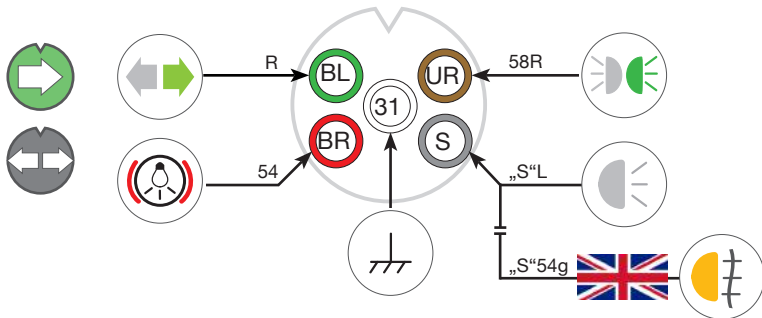
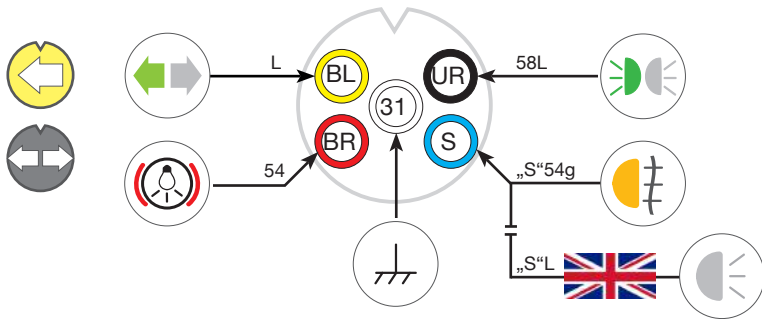

- 1.
- 2.
- 3.
- 4.
- 5.

Imax=16A



Imax=16A



Bayonet  
5 pin

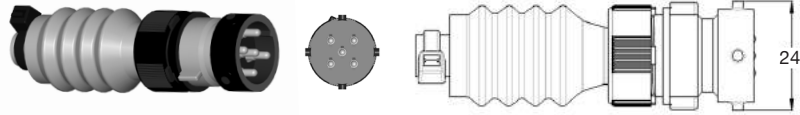

SPARE PART NO.: 13-0536-044

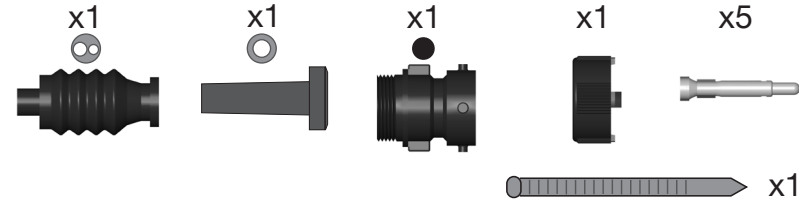

Bayonet  
5 pin

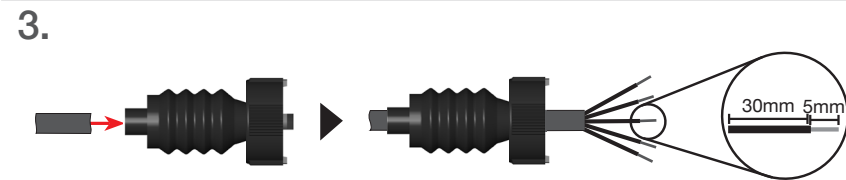
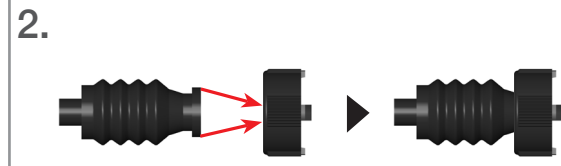
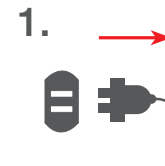
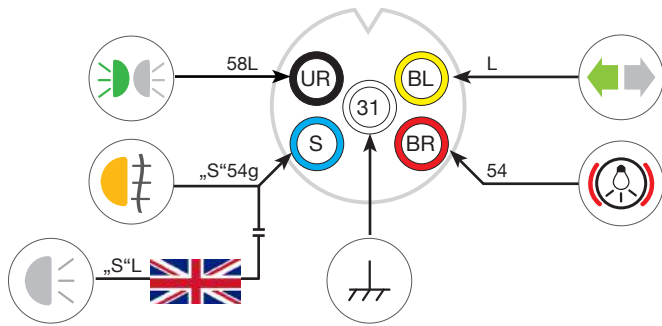
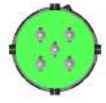
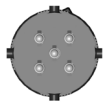
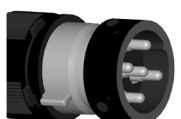
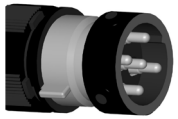

Imax=16A

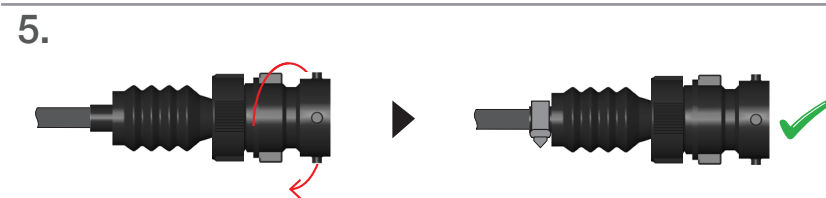
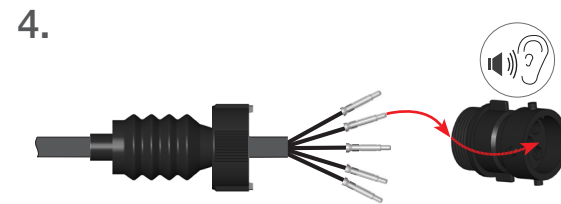
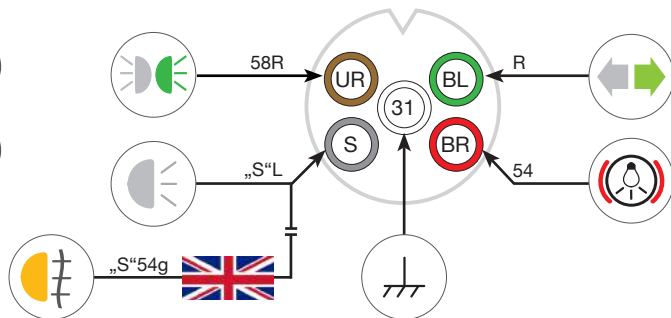

Imax=16A



Bayonet 8 pin



SPARE PART NO.: 13-0828-034

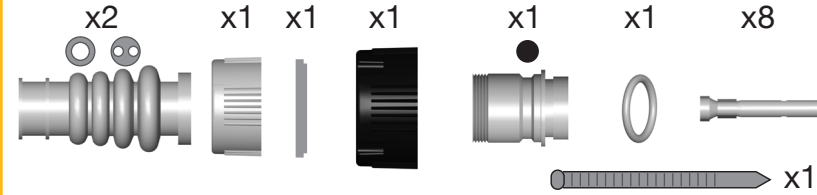

Bayonet 8 pin

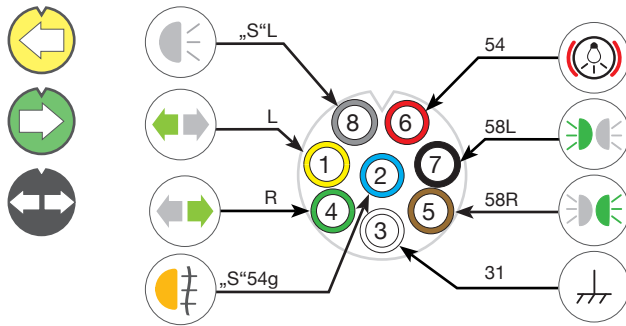
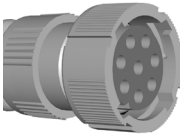
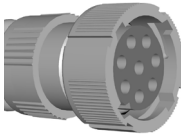

1. Plug the cable into the connector housing.
2. Insert the housing into the main connector housing.
3. Tighten the nut onto the housing.
4. Insert the 8-pin insert into the housing.
5. Insert the 8 pins into the insert. A callout shows a 30mm length and a 5mm diameter for the pins.
6. Tighten the screw to secure the pins. A green checkmark indicates the final assembly is complete.

I<sub>max</sub>=16A

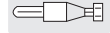

I<sub>max</sub>=16A



Bayonet 8 pin

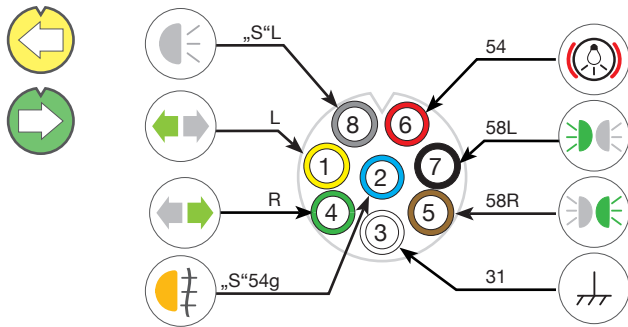
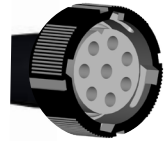
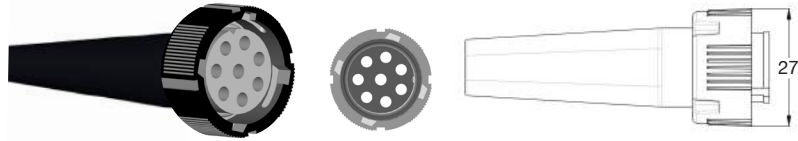

I<sub>max</sub>=16A



Bayonet 8 pin

SPARE PART NO.: 15-0821-524



I<sub>max</sub>=16A



1. Plug the connector into the power source.
2. Insert the ring into the housing.
3. Push the housing onto the ring.
4. Tighten the screws. A 30mm x 5mm torque wrench is recommended.
5. Check the connection. A green checkmark indicates a successful assembly.

Bayonet  
8 pin

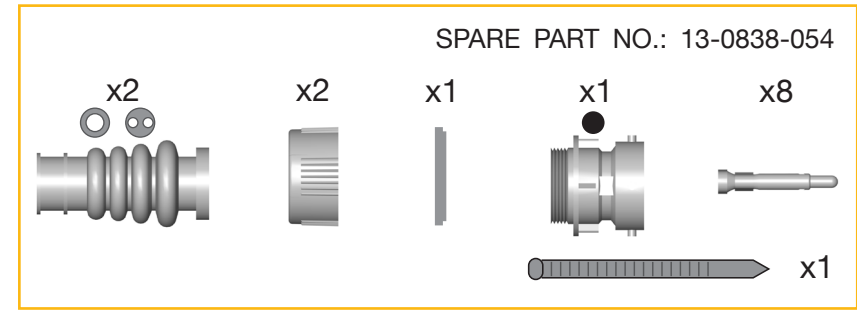

Bayonet  
8 pin

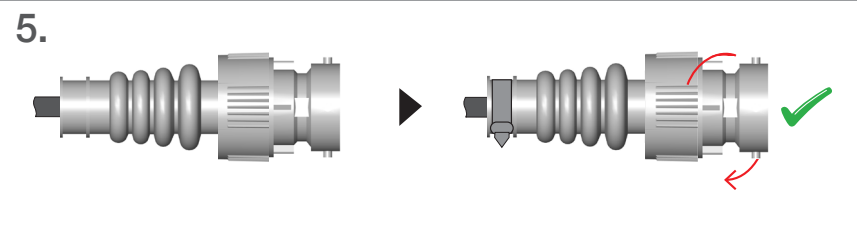
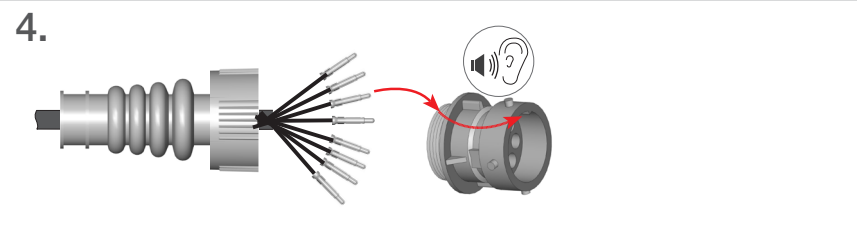
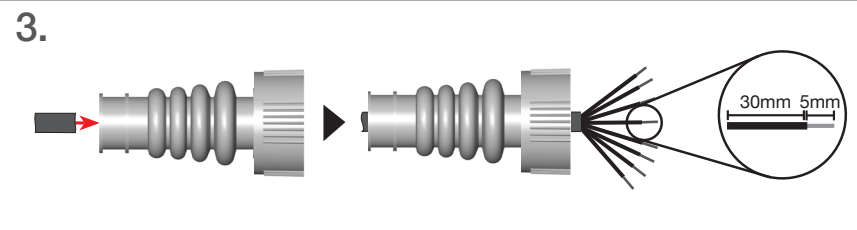
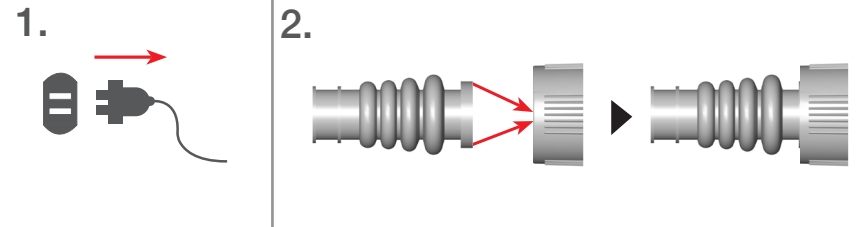
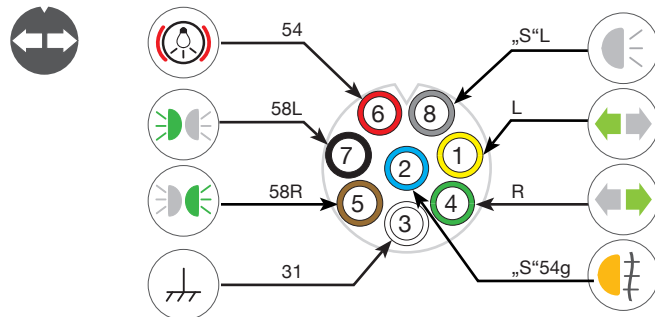
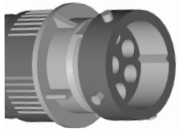
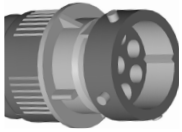

Imax=16A



Imax=16A



Bayonet  
15 pin

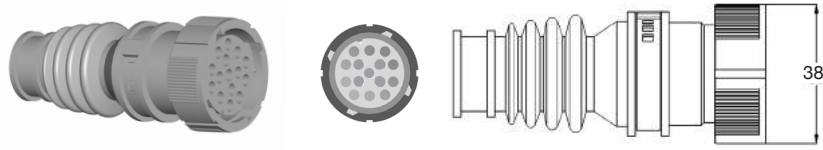

SPARE PART NO.: 13-1540-004

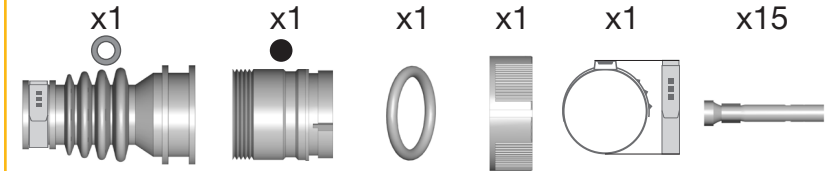

Bayonet  
15 pin

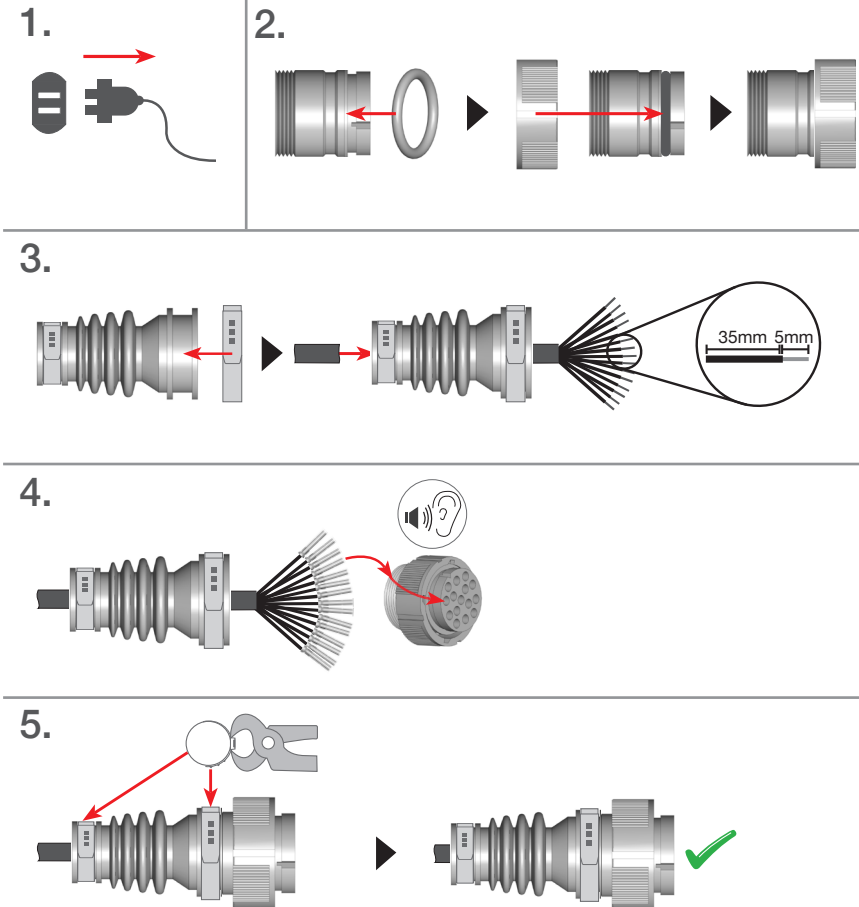
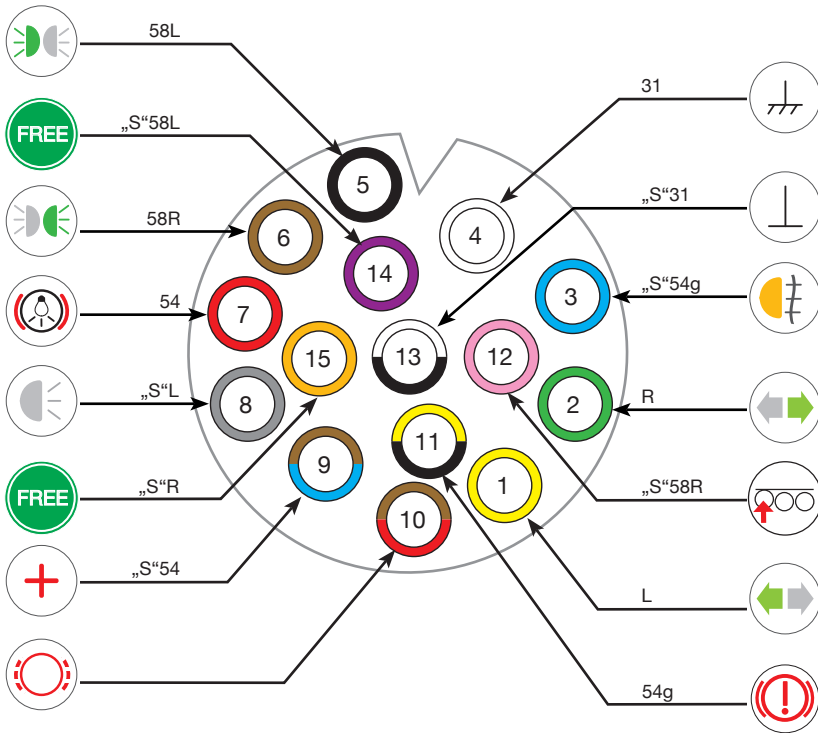

Imax=16A



Imax=16A





Bayonet  
15 pin



SPARE PART NO.: 13-1530-004

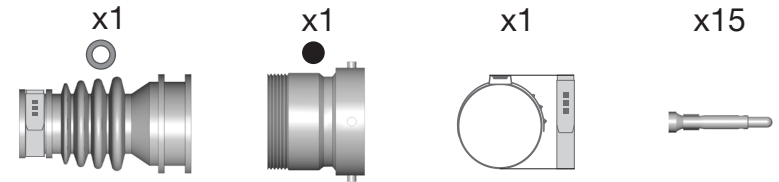

Bayonet  
15 pin

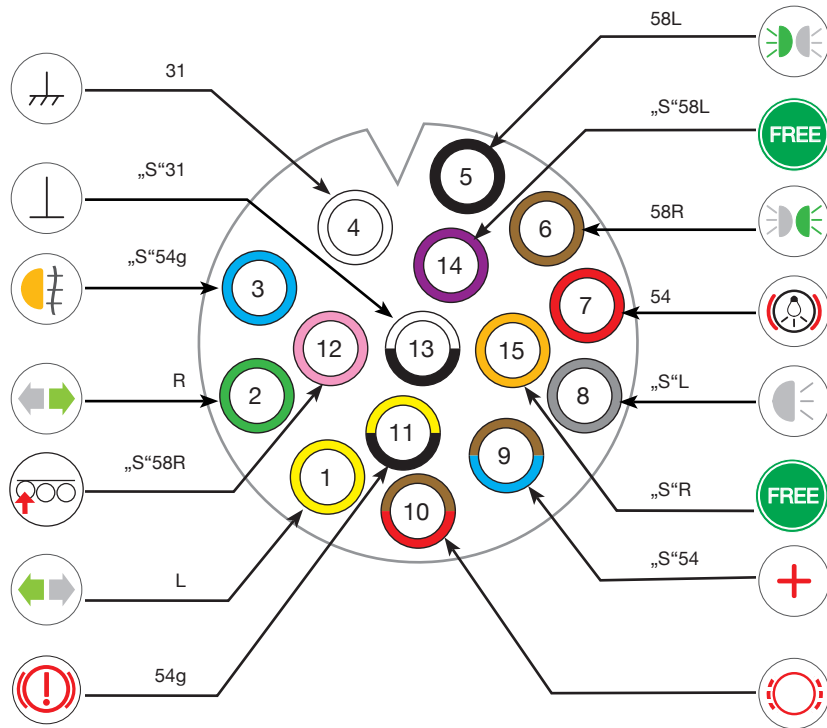
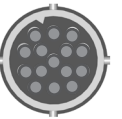
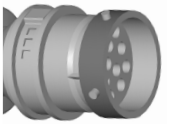
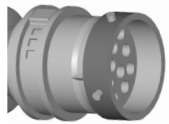

1. Plug the connector into the mating socket.
2. Push the connector into the socket until it is fully seated.
3. Push the connector into the socket until the pins are fully inserted. A 35mm x 5mm dimension is shown for the pin insertion depth.
4. Push the connector into the socket until the pins are fully inserted. A 35mm x 5mm dimension is shown for the pin insertion depth.
5. Push the connector into the socket until the pins are fully inserted. A 35mm x 5mm dimension is shown for the pin insertion depth.

Imax=16A



Imax=16A





ASS1,  
ASS2  
2 pin

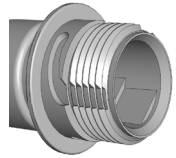

Imax=25A



ASS 1

ASS 2



IP68

IP6K9K

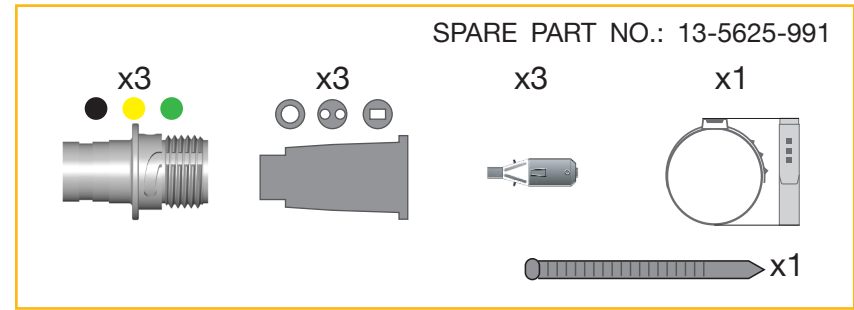
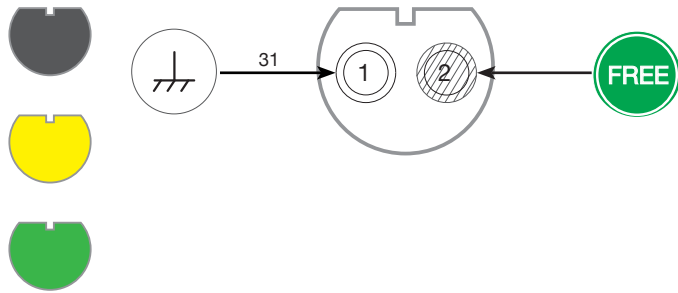
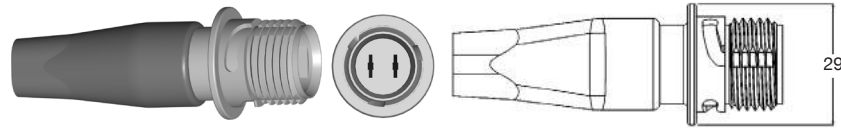

ASS1,  
ASS2  
2 pin

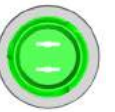
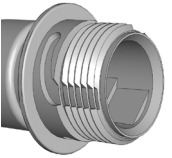

Imax=25A







IP68

- 1.
- 2.
- 3.
- 4.
- 5.

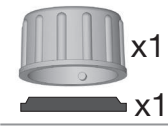
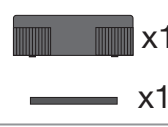
ASS1,  
ASS2,  
ASS2.1,  
7 pin

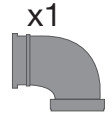
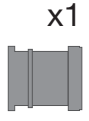
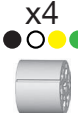

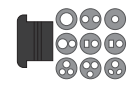
|  |  |   |
|--|--|---|
| <p>ASS 2</p>  <p>x1</p> | <p>ASS 1</p>  <p>x1</p> | <p>SPARE PART NO.: 13-5626-631</p>  <p>x1</p>  |
|  <p>x1</p>              |  <p>x1</p>              |  <p>x4</p>  <p>x9</p>  <p>x9</p> |

ASS1,  
ASS2,  
ASS2.1,  
7 pin

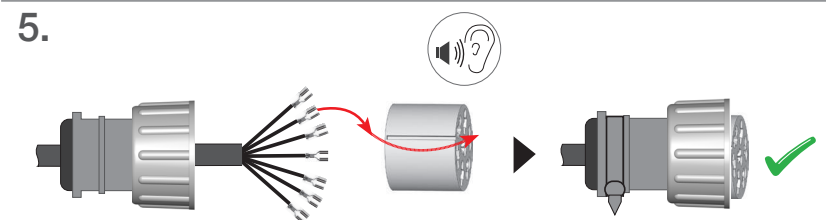
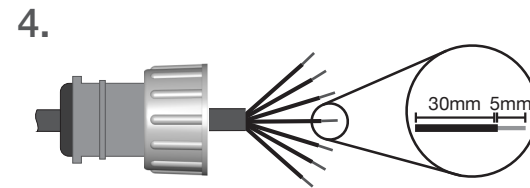
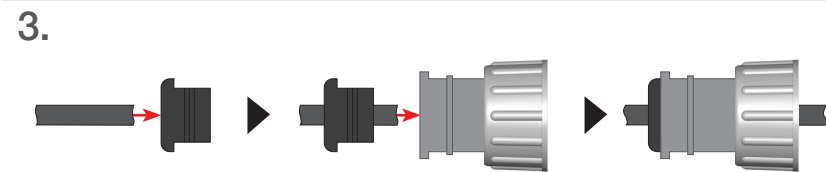
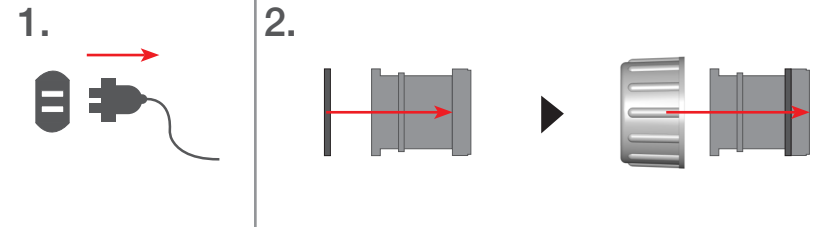
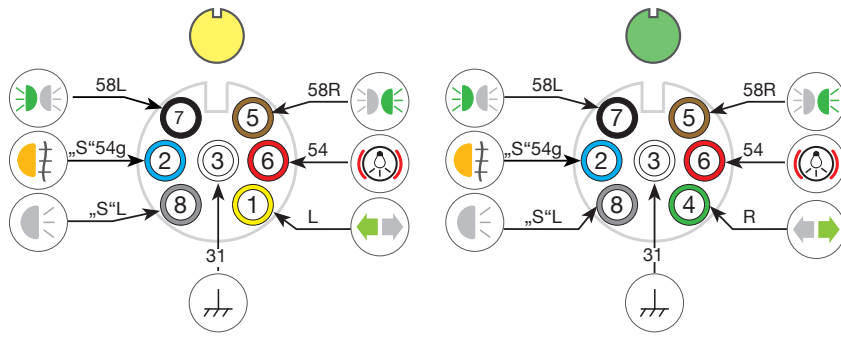

Imax=25A



ASS 1 ASS 2,2.1



Imax=25A



ASS1,  
ASS2,  
ASS2.1,  
7 pin

ASS1,  
ASS2,  
ASS2.1,  
7 pin



SPARE PART NO.: 13-5625-981

x4 (Black, White, Yellow, Green)  
x1  
x9  
x9  
x2

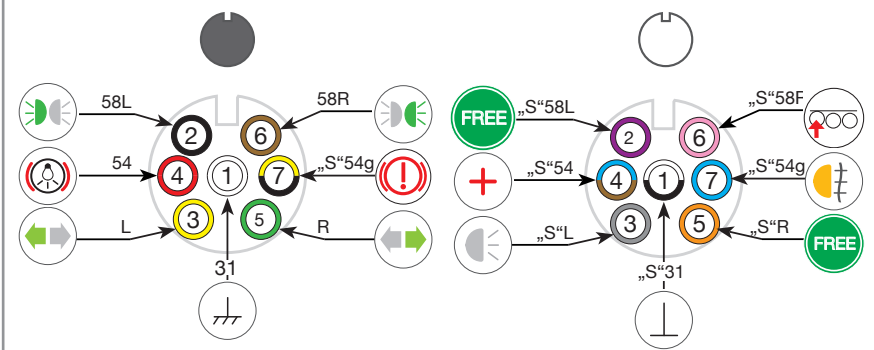
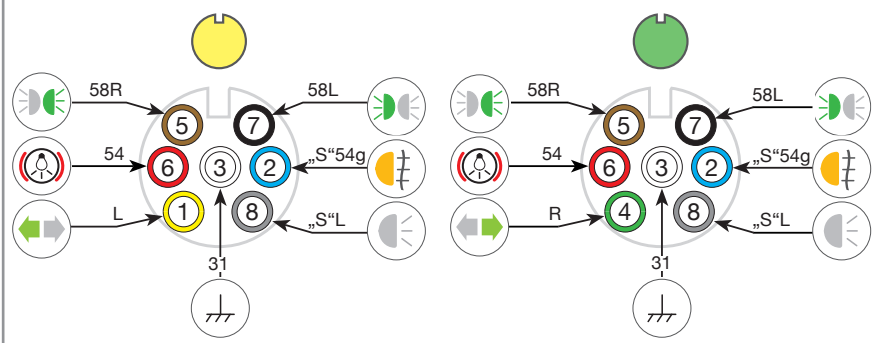

1. Plug the cable into the connector.
2. Push the sleeve onto the cable and the plug.
3. Push the pins into the sleeve.
4. Push the sleeve into the shell. Dimensions: 30mm, 5mm.
5. Push the shell onto the sleeve and plug. Use pliers to secure the shell.

Imax=25A

ASS 1 ASS 2,2.1

ADR-Zone 2 approved IP68

ADR-Zone 2 approved IP6K9K

Imax=25A

ADR-Zone 2 approved IP68

ASS3  
3 pin

ASS3  
3 pin

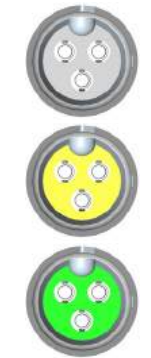
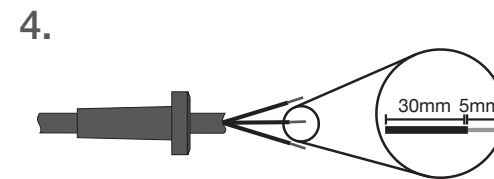
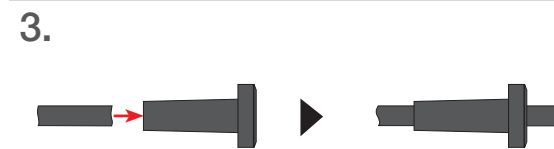
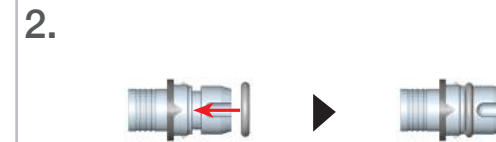
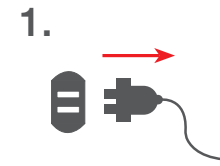
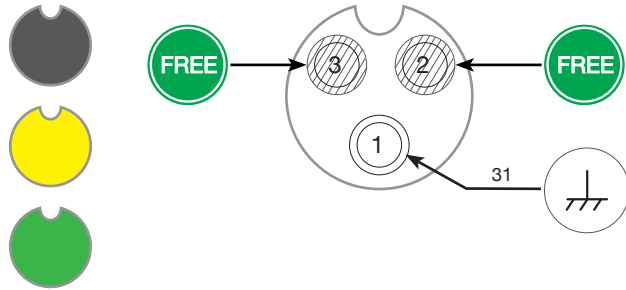
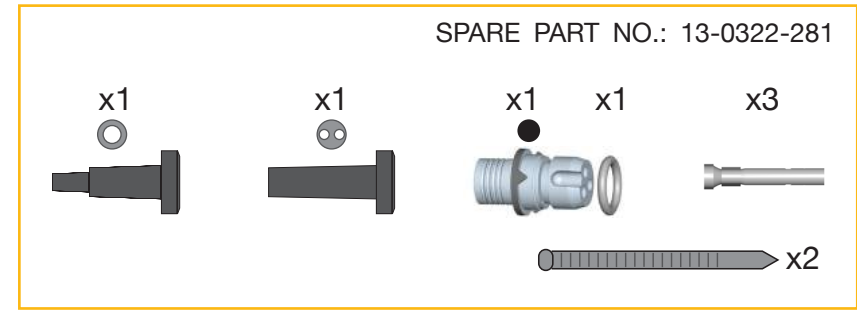

I<sub>max</sub>=16A

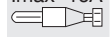

I<sub>max</sub>=16A



ASS3  
3 pin

ASS3  
3 pin

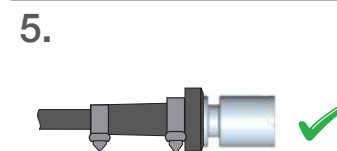
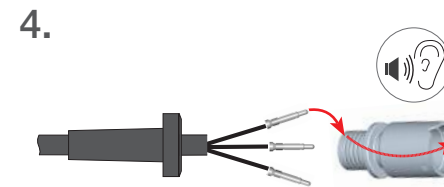
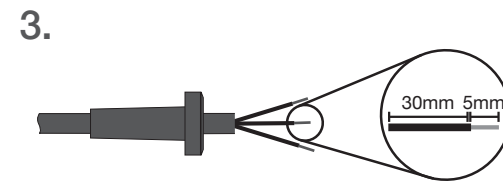
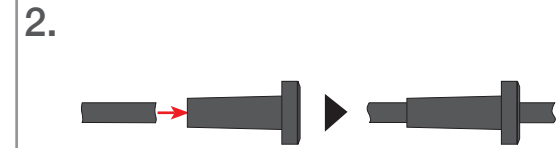
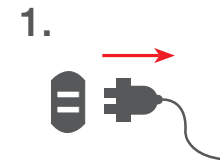
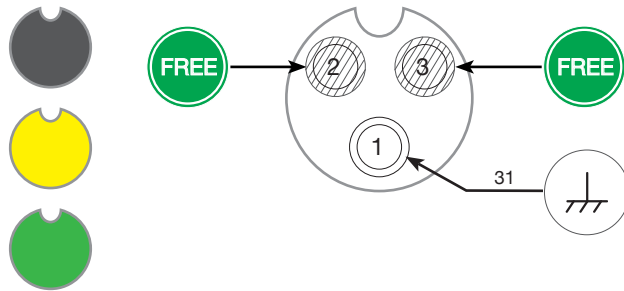
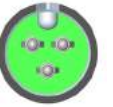
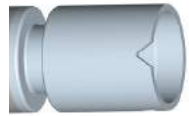
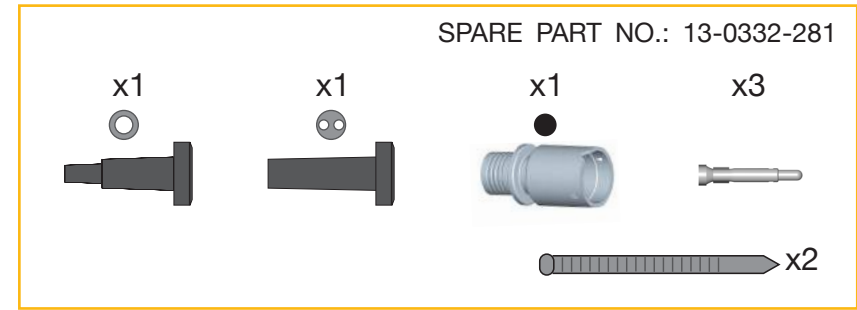

I<sub>max</sub>=16A



I<sub>max</sub>=16A





# ASS3 17 pin female

# Mounting instruction ASS3 17 pin female

ASS3  
17 pin



SPARE PART NO.: 13-1722-001

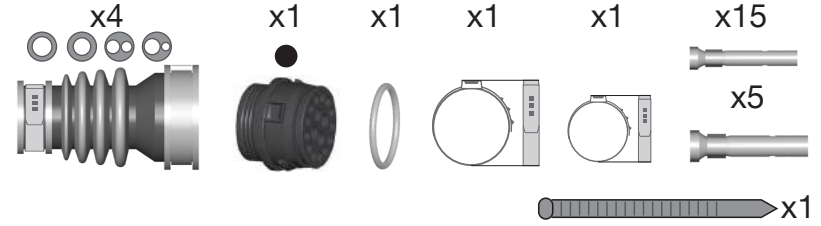

ASS3  
17 pin

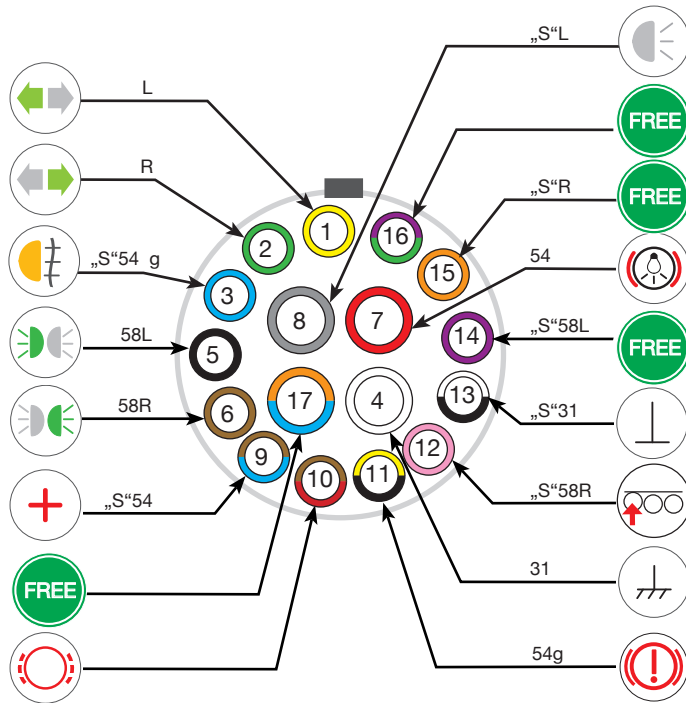

- 
- 
- 
- 
- 

Imax=16A



Imax=16A



# ASS3 17 pin male

# Mounting instruction ASS3 17 pin male

ASS3  
17 pin

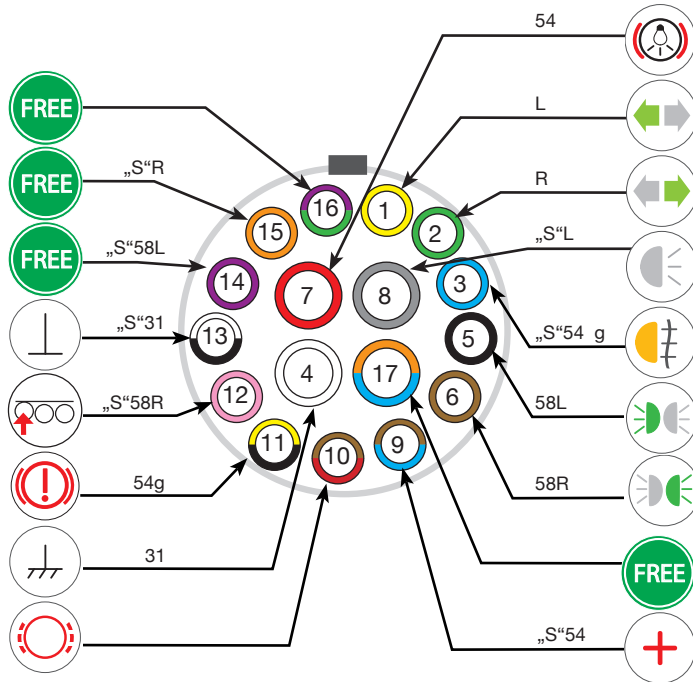
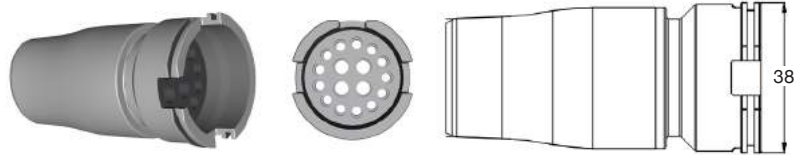

Imax=16A

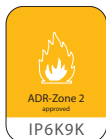

SPARE PART NO.: 13-1732-001

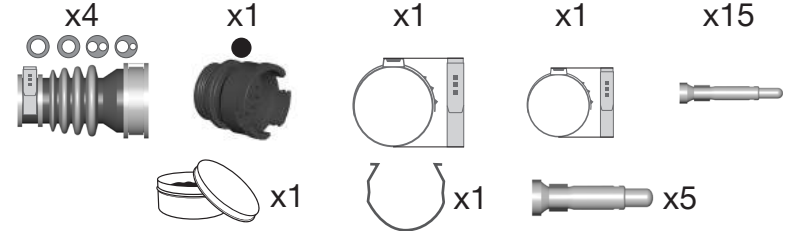

ASS3  
17 pin



1. Plug the connector into the mating socket.
2. Push the cap onto the connector.
3. Insert the pins into the contact plate.
4. Push the contact plate into the main body.
5. Push the cap back onto the connector.

Imax=16A

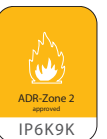

AMP  
4 pin



SPARE PART NO.: 15-7002-004

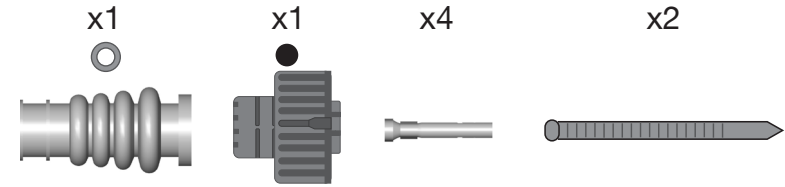

AMP  
4 pin

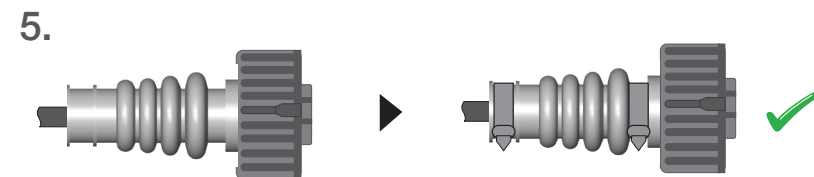
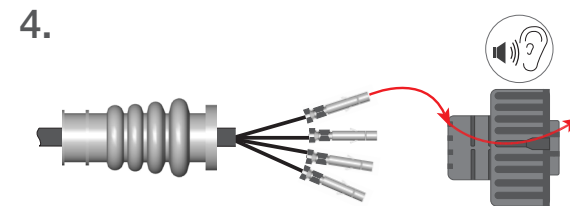
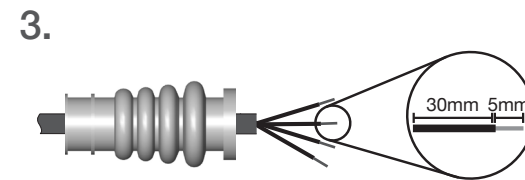
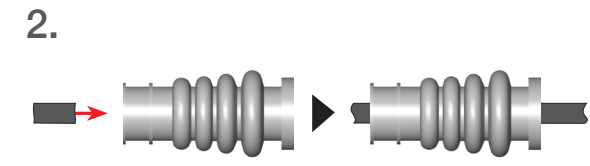
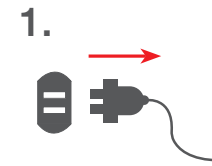
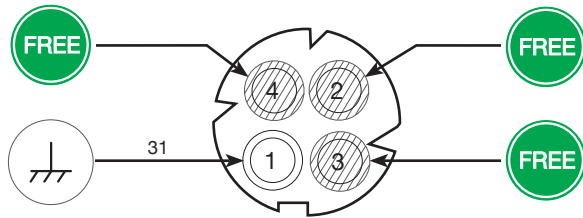

I<sub>max</sub>=40A

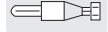

I<sub>max</sub>=40A



AMP  
4 pin

AMP  
4 pin

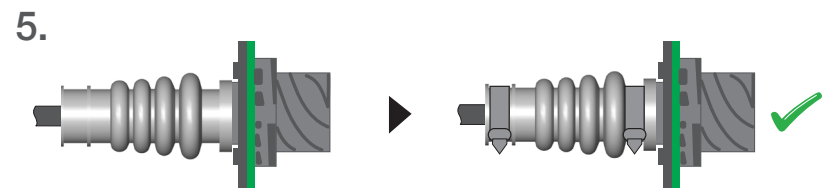
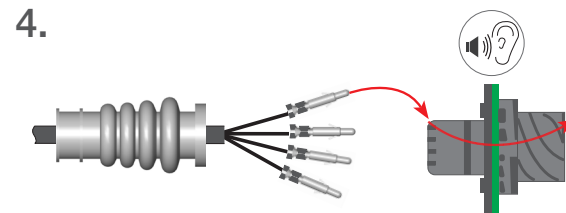
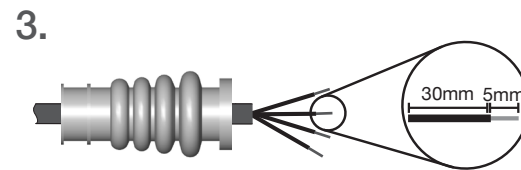
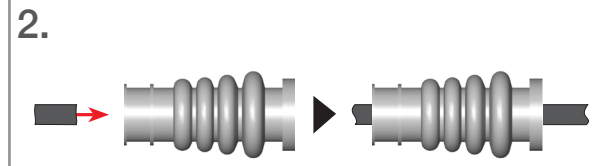
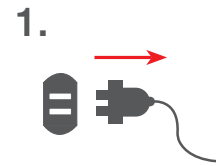
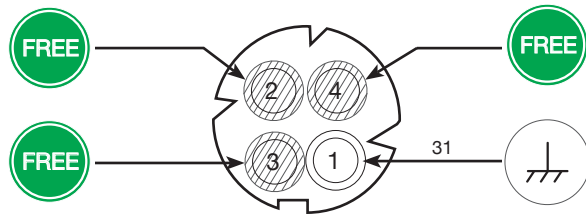
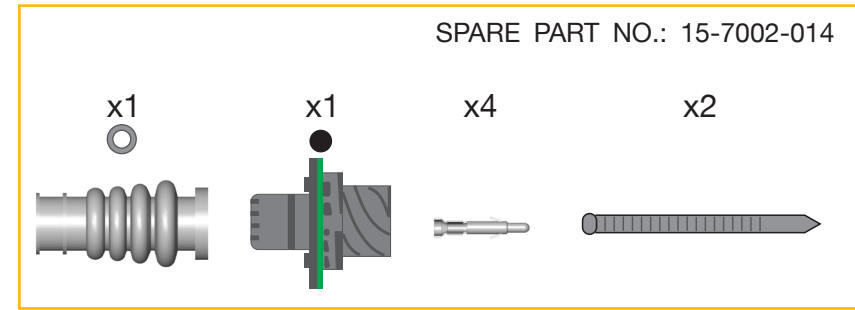

I<sub>max</sub>=40A



I<sub>max</sub>=40A



# AMP 7 pin female

# Mounting instruction AMP 7 pin female

AMP  
7 pin

AMP  
7 pin

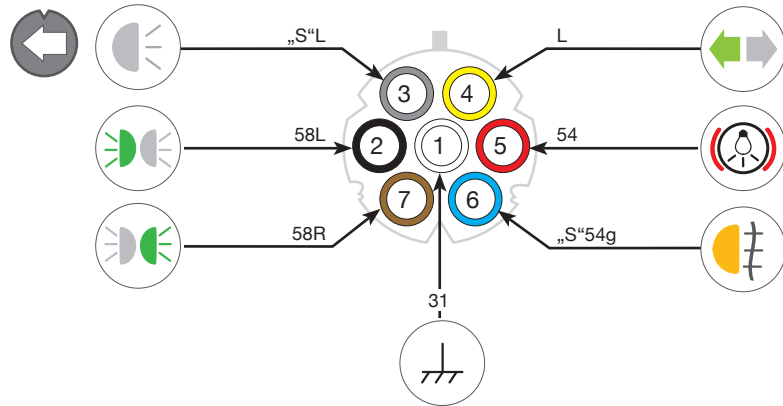
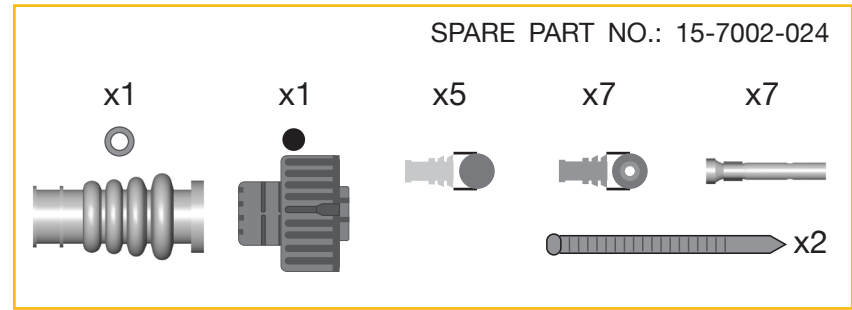

1. Insert the contact sleeve into the housing.
2. Push the contact pins into the sleeve.
3. Trim the contact pins to a length of 30mm and 5mm.
4. Insert the contact pins into the housing.
5. Push the housing onto the contact sleeve.

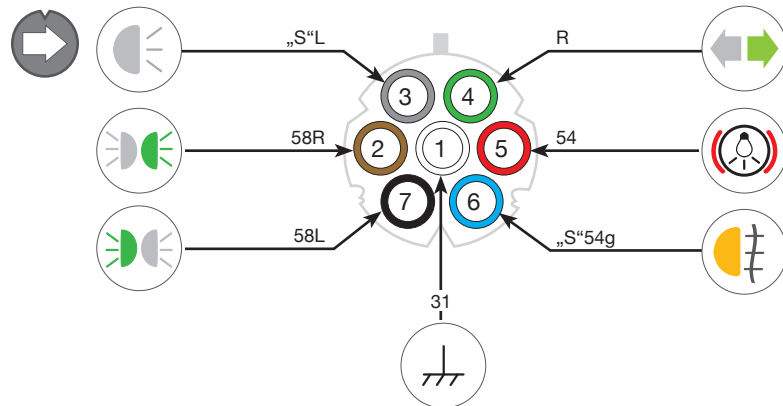

Imax=30A



Imax=30A

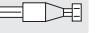

AMP  
7 pin

AMP  
7 pin

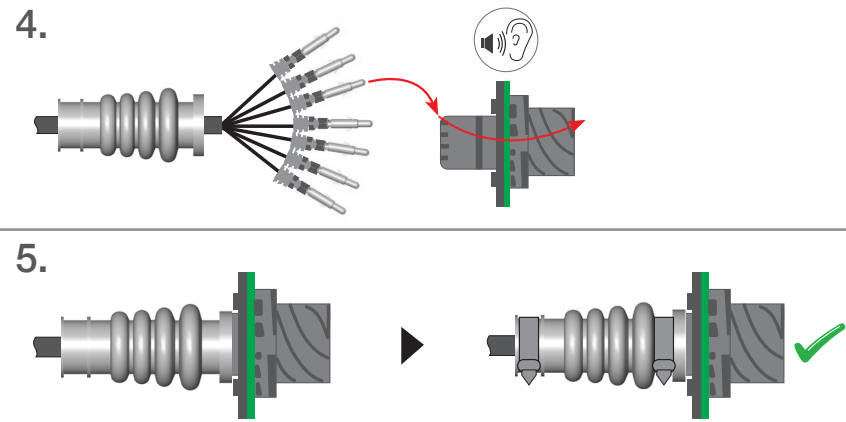
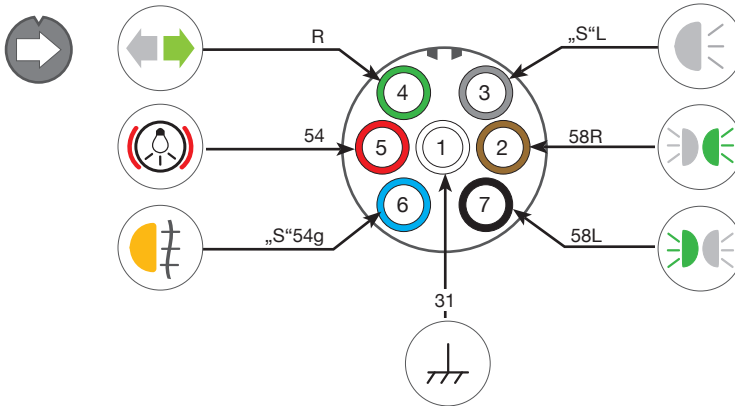
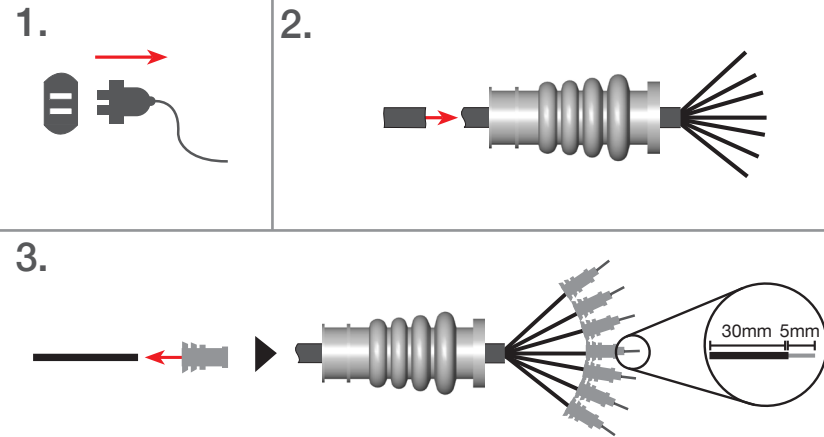
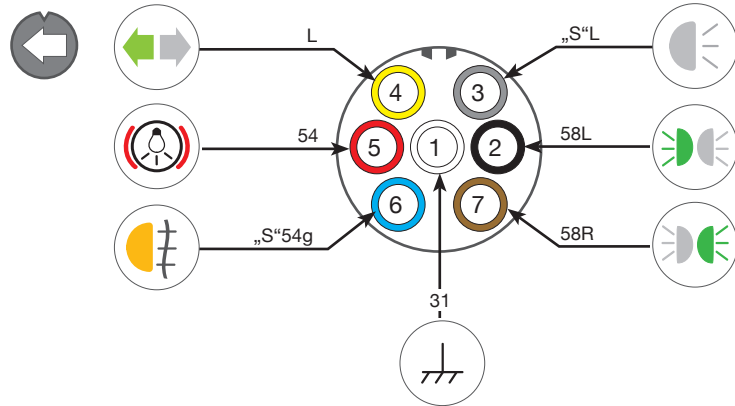
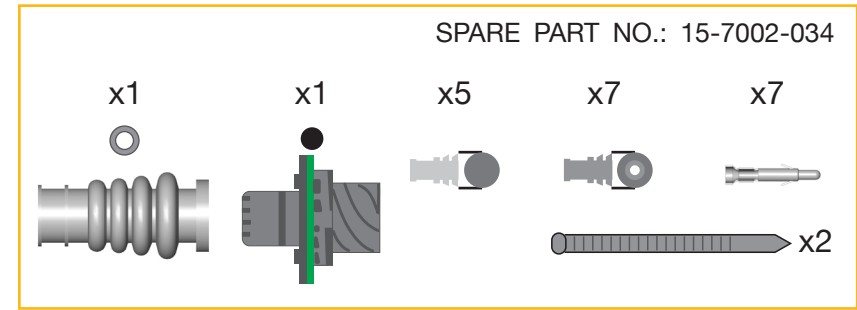

Imax=30A



Imax=30A

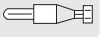

SuperSeal  
2 pin

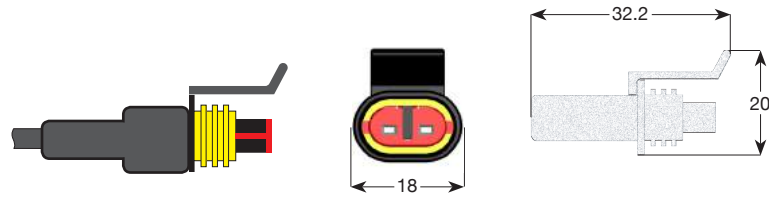

SPARE PART NO.: 15-7002-044

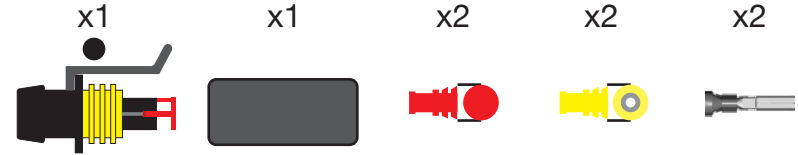

SuperSeal  
2 pin

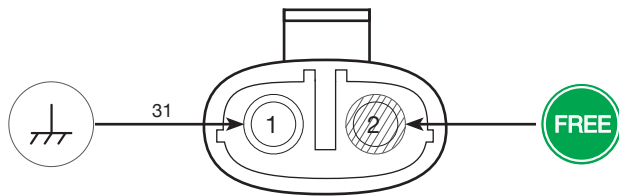

- 1.
- 2.
- 3.
- 4.
- 5.

I<sub>max</sub>=14A

I<sub>max</sub>=14A



SuperSeal  
2 pin

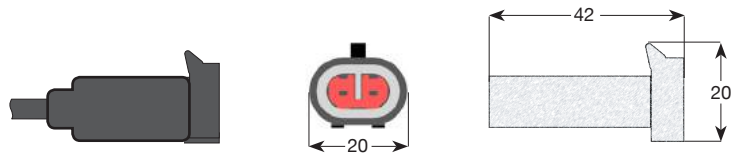

SPARE PART NO.: 15-7002-054

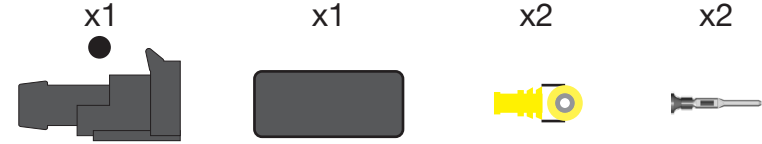

SuperSeal  
2 pin

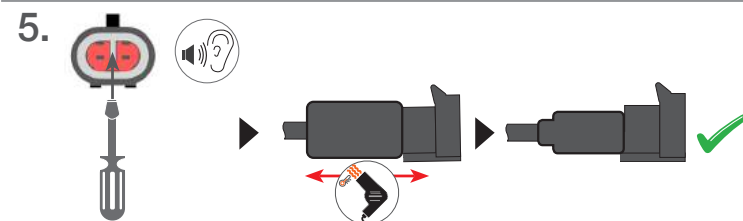
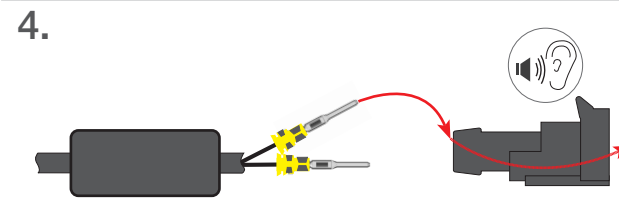
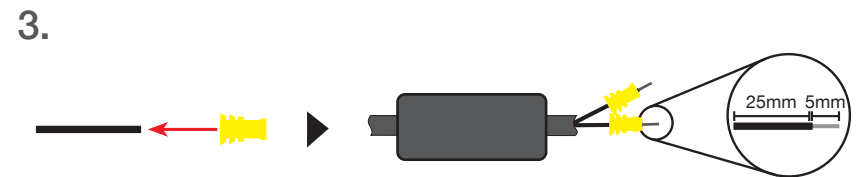
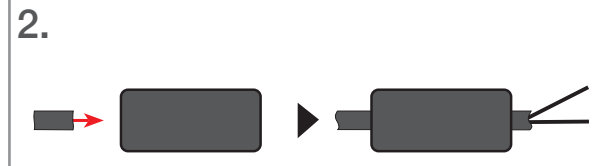
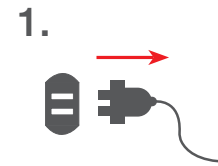
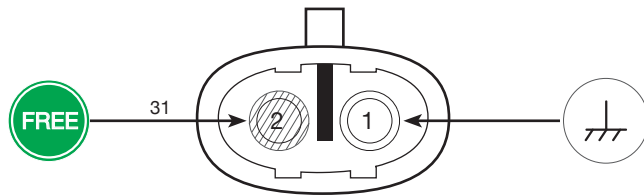

Imax=14A

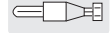

Imax=14A

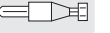

SuperSeal  
3 pin

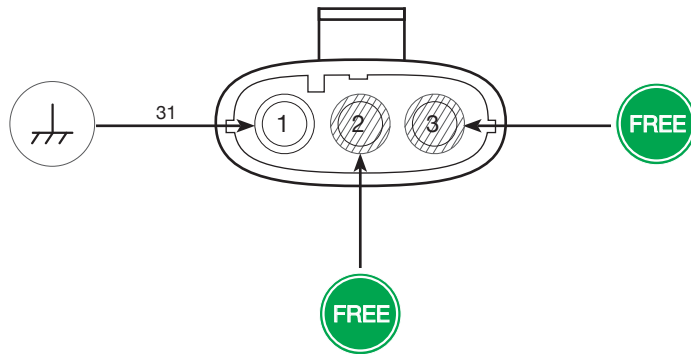
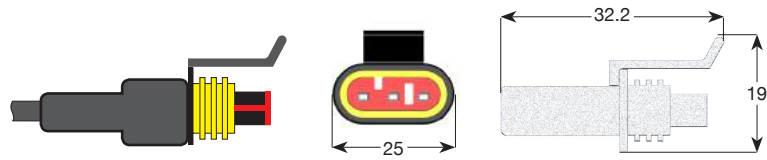

I<sub>max</sub>=14A



SuperSeal  
3 pin



SPARE PART NO.: 15-7002-064

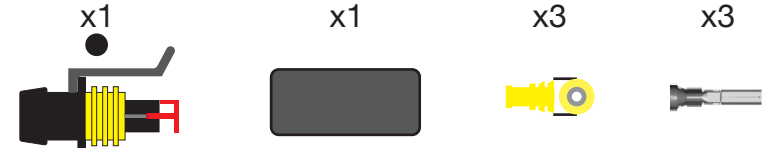

- 1.
- 2.
3.   
30mm 5mm
4.   
CLICK
5.   
CLICK

I<sub>max</sub>=14A



SuperSeal  
3 pin

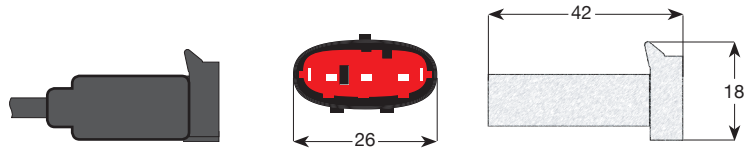

SPARE PART NO.: 15-7002-074

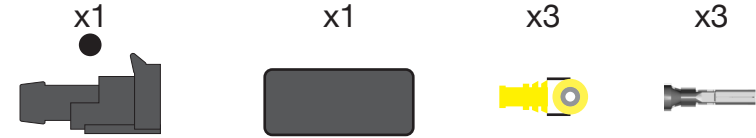

SuperSeal  
3 pin

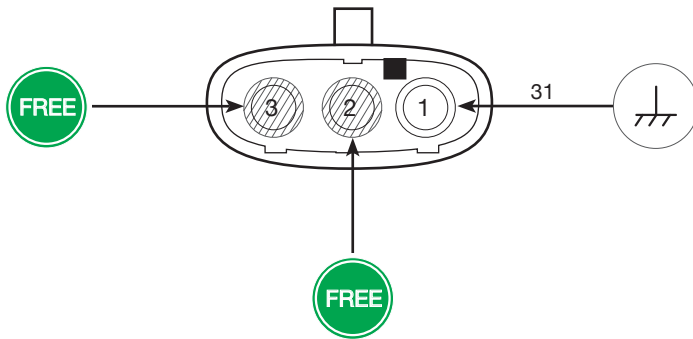

- 1.
- 2.
- 3.
- 4.
- 5.

$I_{max}=14A$

$I_{max}=14A$

SuperSeal  
4 pin

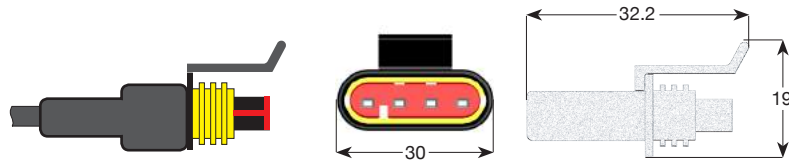

SPARE PART NO.: 15-7002-084

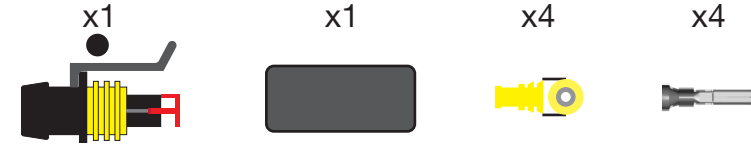

SuperSeal  
4 pin

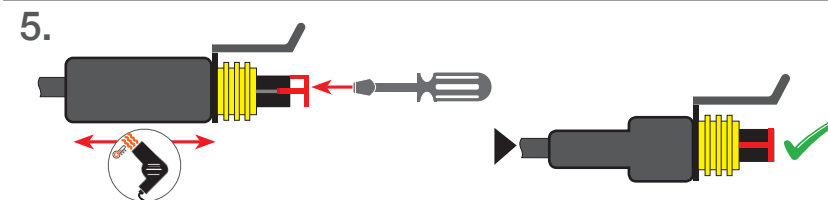
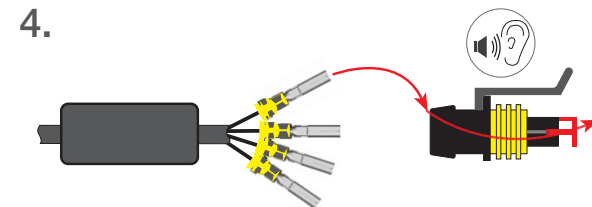
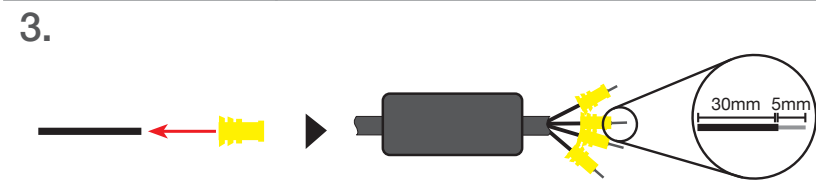
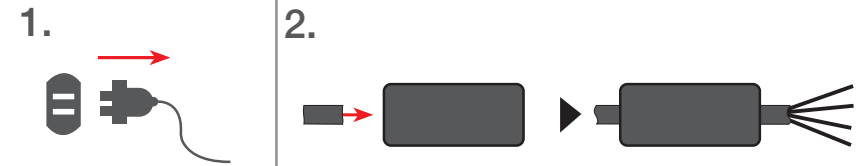
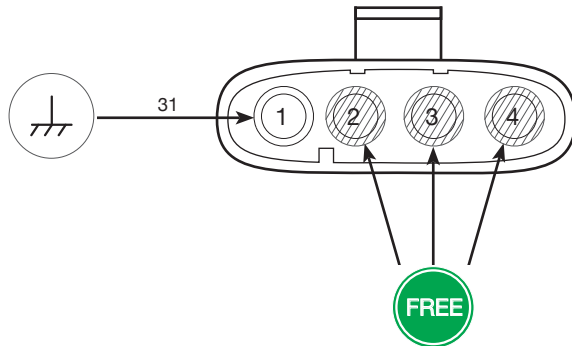

Imax=14A

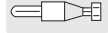

Imax=14A

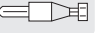

SuperSeal  
4 pin

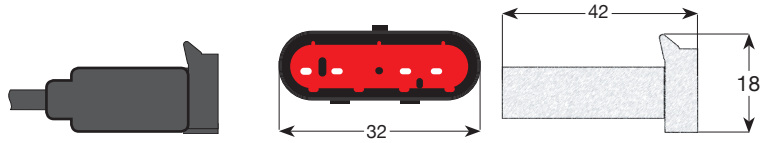

SPARE PART NO.: 15-7002-094

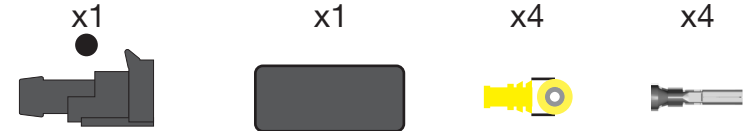

SuperSeal  
4 pin

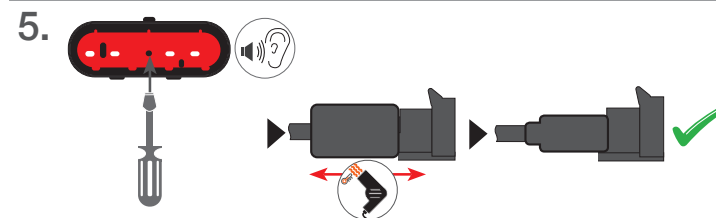
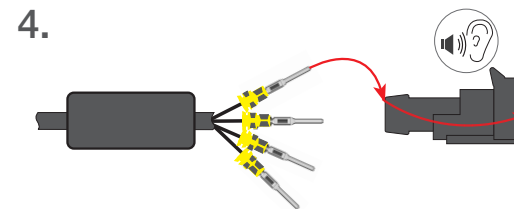
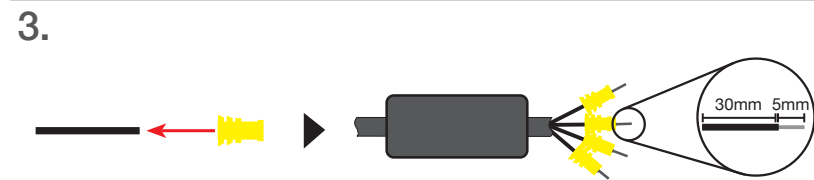
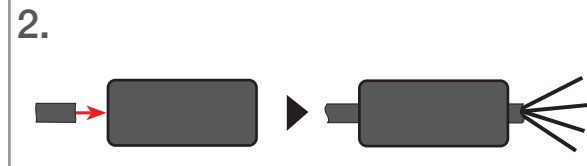
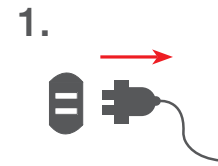
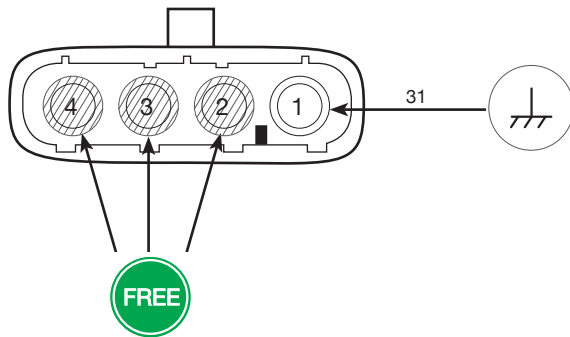

I<sub>max</sub>=14A

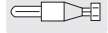

I<sub>max</sub>=14A



SuperSeal  
6 pin

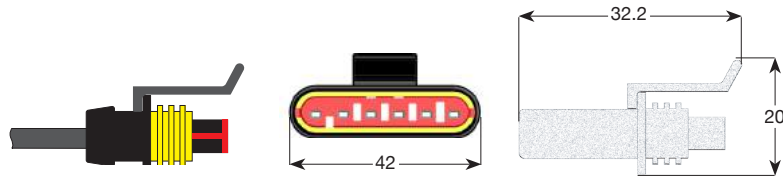

SPARE PART NO.: 15-7002-104

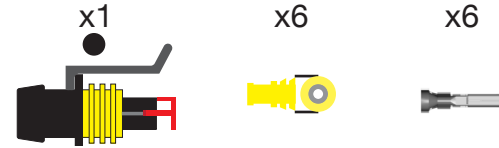

SuperSeal  
6 pin

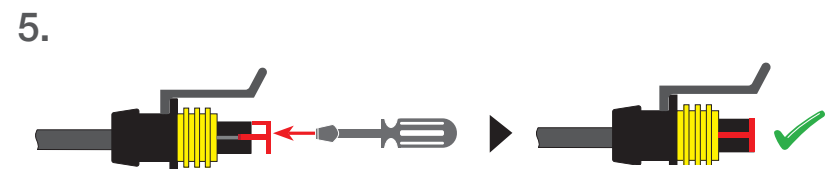
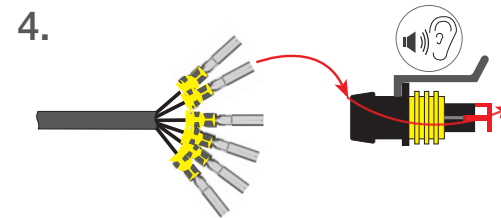
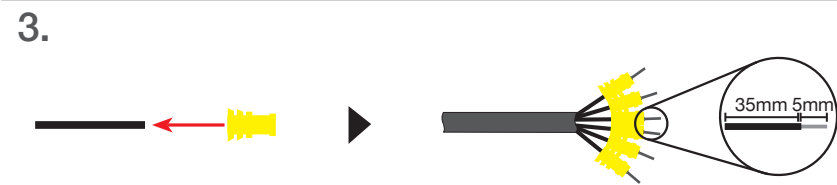
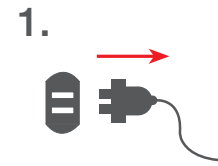
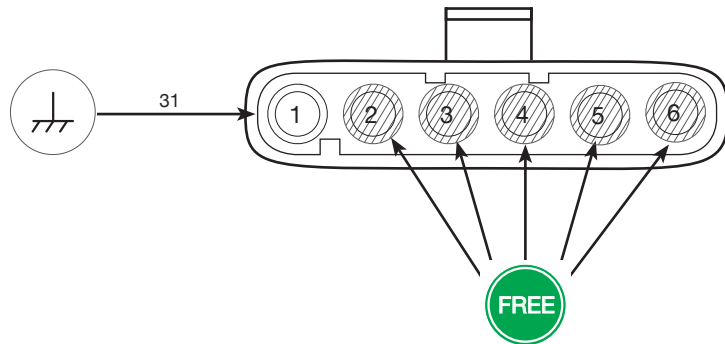

Imax=14A

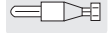

Imax=14A

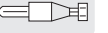

SuperSeal 6 pin

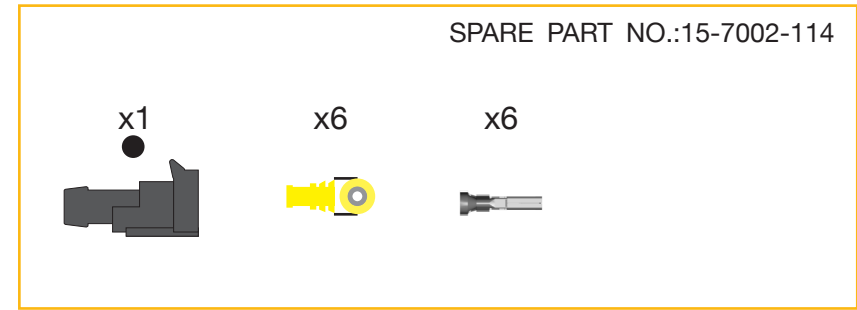
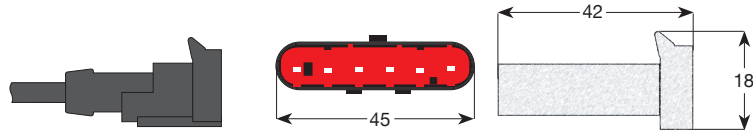

SuperSeal 6 pin

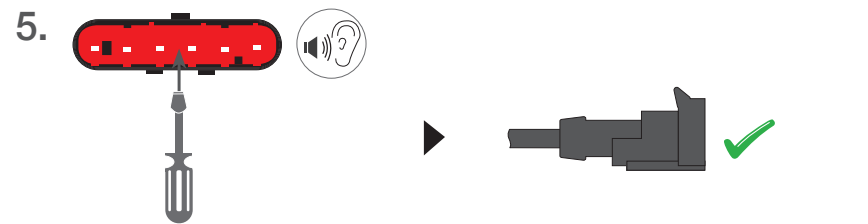
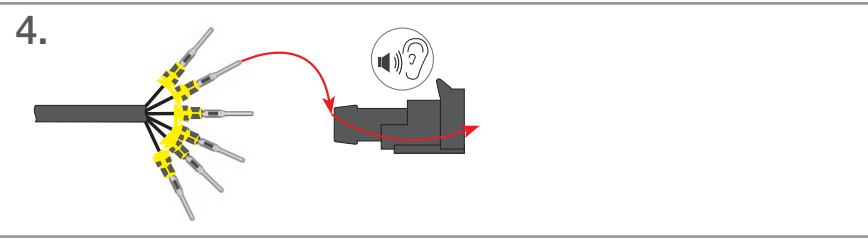
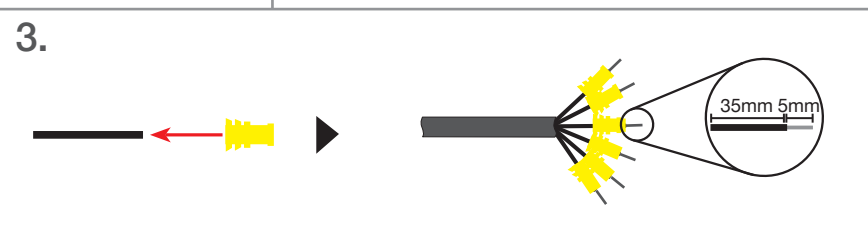
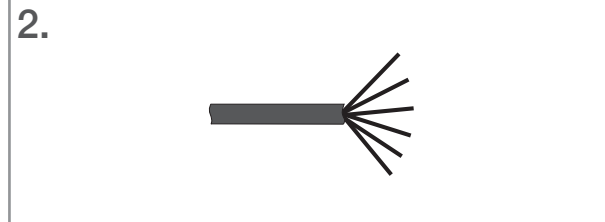
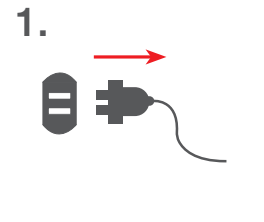
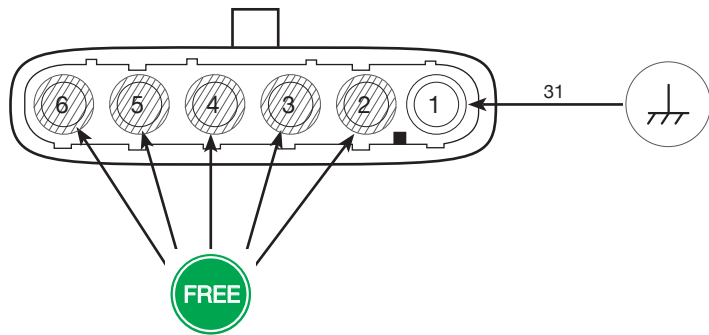

Imax=14A

Imax=14A



DEUTSCH  
2 pin

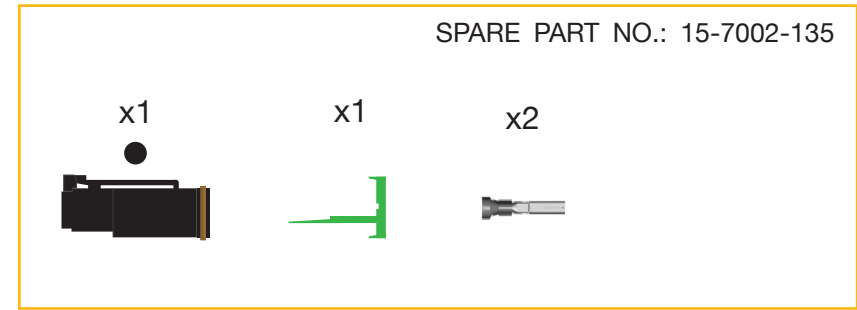
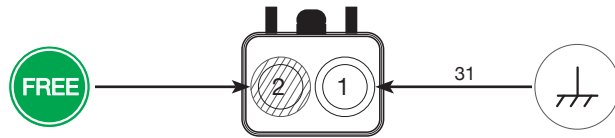
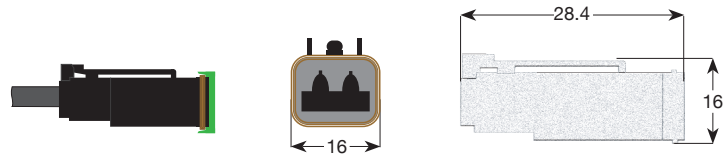

DEUTSCH  
2 pin

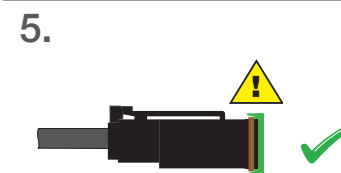
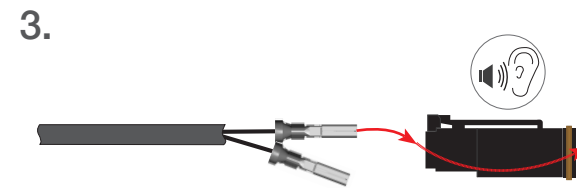
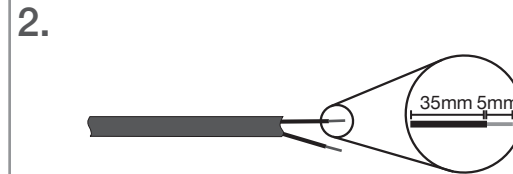
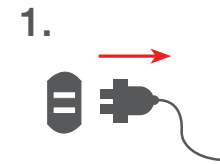
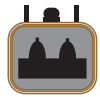

I<sub>max</sub>=13A

I<sub>max</sub>=13A

DEUTSCH  
2 pin



SPARE PART NO.: 15-7002-125

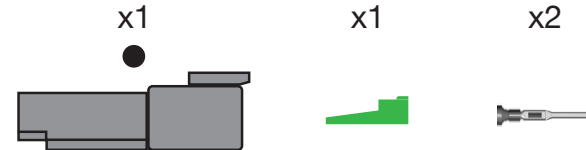

DEUTSCH  
2 pin

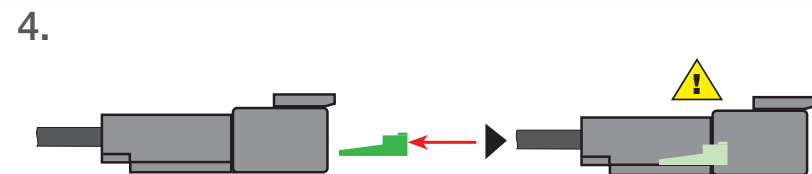
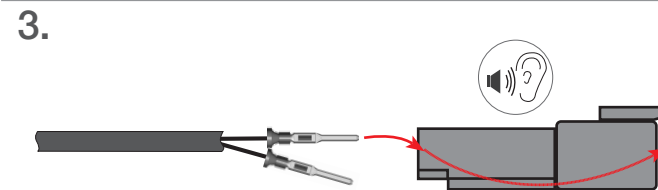
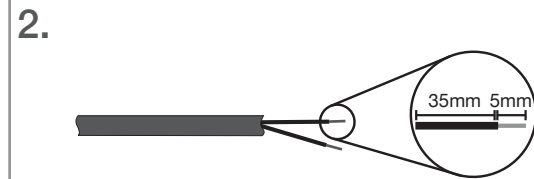
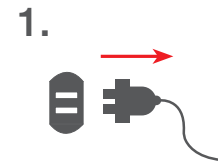
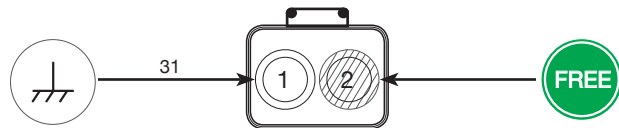

DEUTSCH  
4 pin

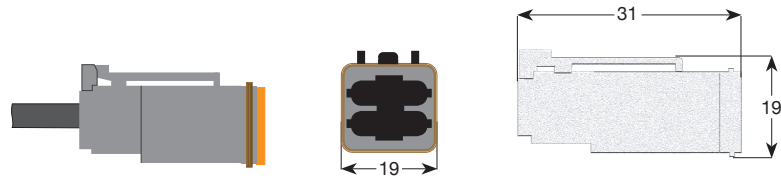

SPARE PART NO.: 15-7002-155

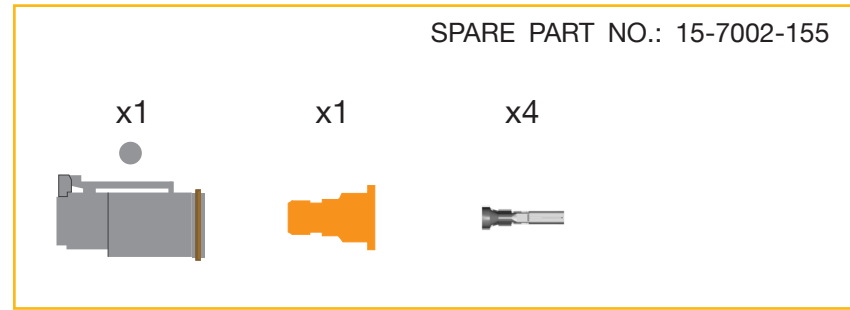

DEUTSCH  
4 pin

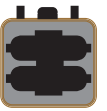
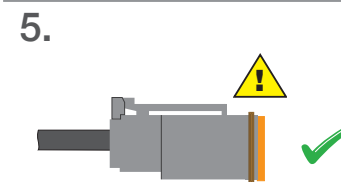
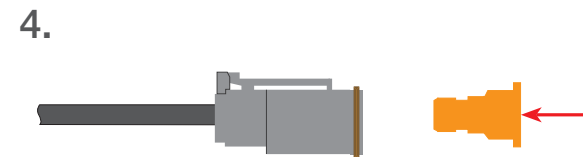
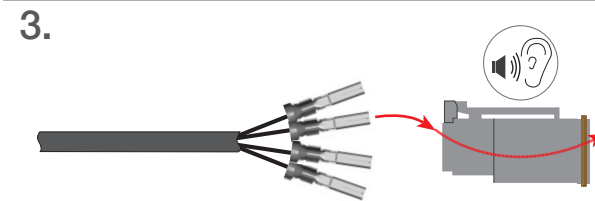
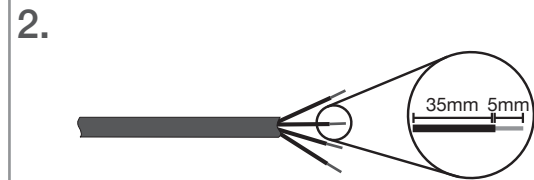
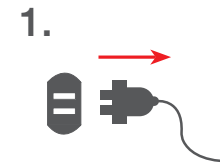
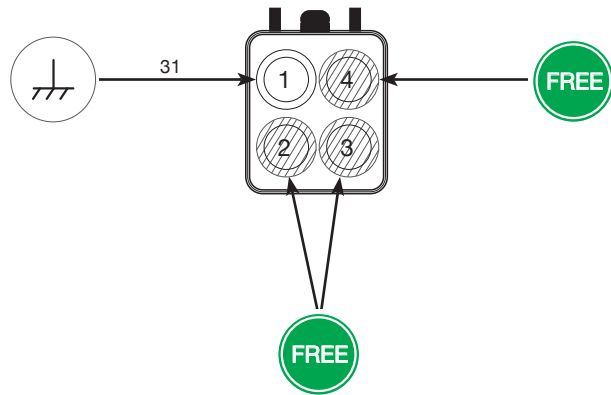

I<sub>max</sub>=13A



I<sub>max</sub>=13A



DEUTSCH  
4 pin

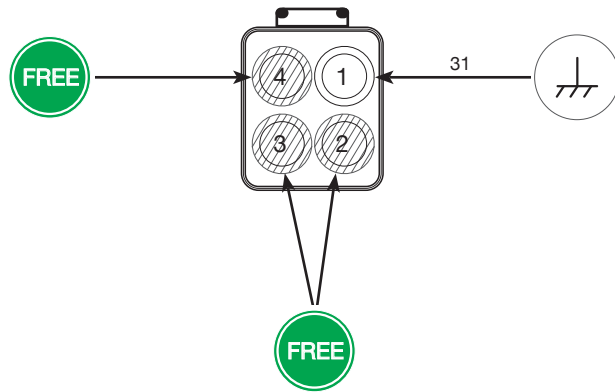
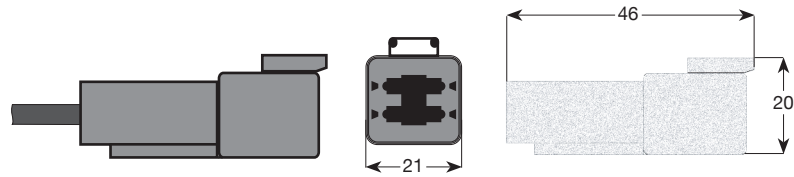

Imax=13A

DEUTSCH  
4 pin



SPARE PART NO.: 15-7002-145

x1      x1      x4

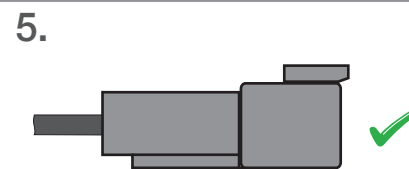
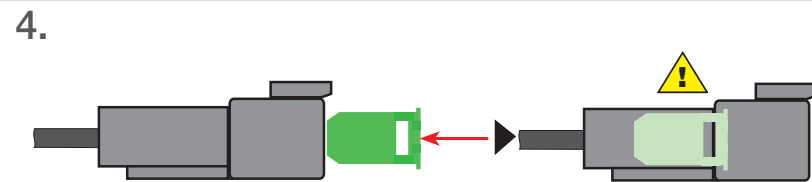
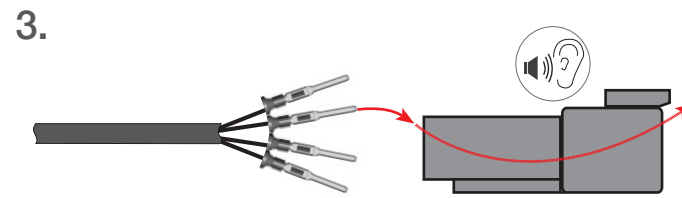
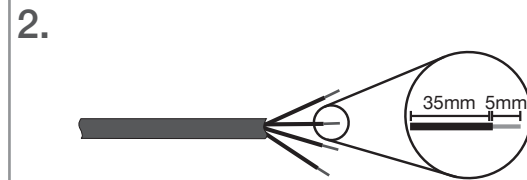
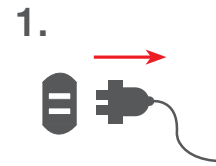

Imax=13A

DEUTSCH  
6 pin

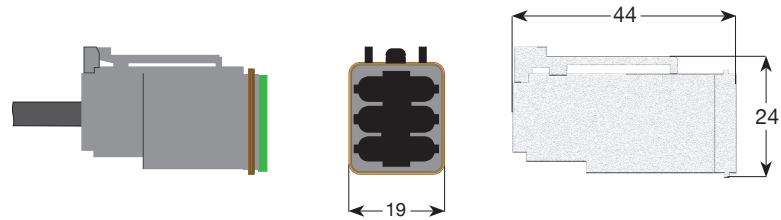

SPARE PART NO.: 15-7002-244

x1

x1

x6



DEUTSCH  
6 pin

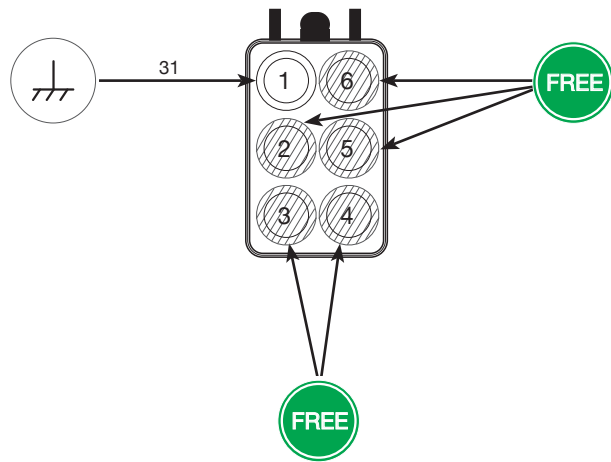

1.

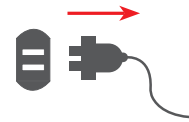

2.

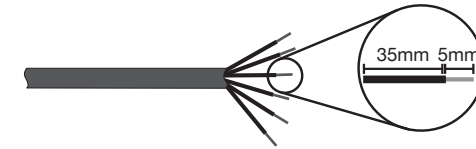

3.

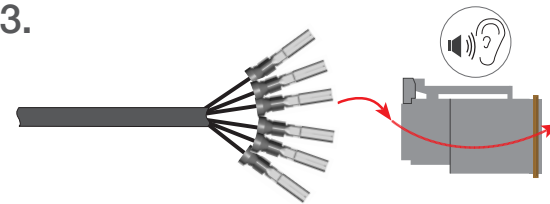

4.



5.

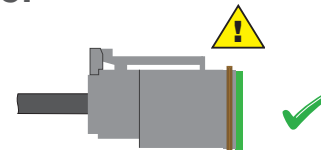

I<sub>max</sub>=13A



I<sub>max</sub>=13A

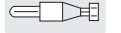



# Caravan connector 3650 16 pin

# ISO 1185 7 pin, ISO 3731 7 pin

3650  
16 pin

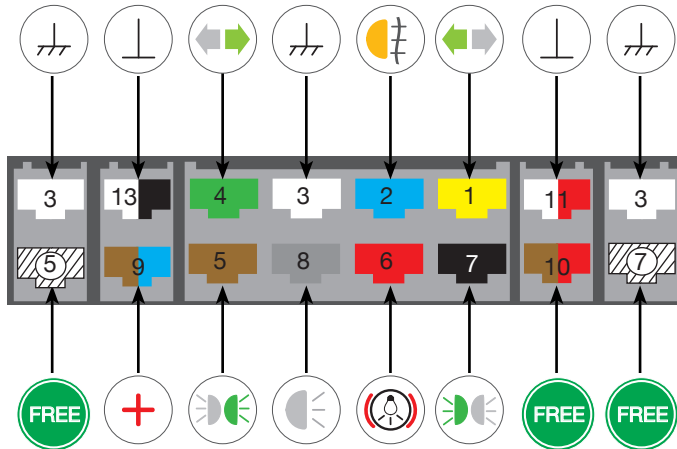
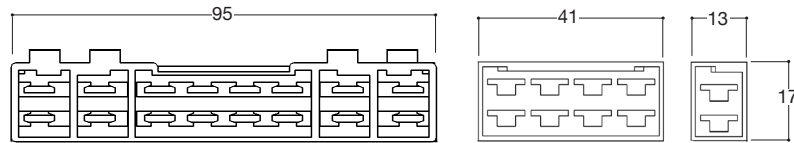

Imax=25A

13-3020-004



13-3128-024



ISO 1185  
7 pin

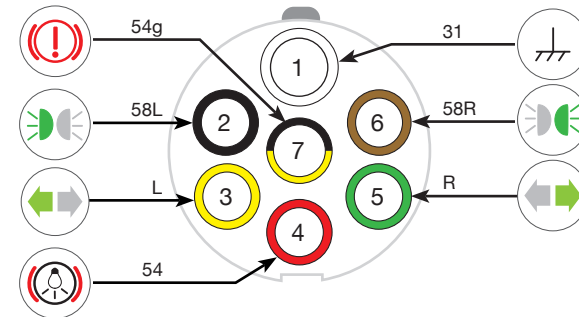

13-3035-004



13-3129-024



ISO 3731  
7 pin

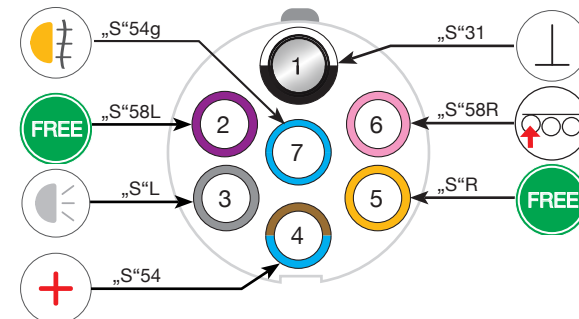
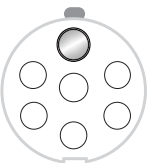

ISO 12098 13 pin

ISO 12098 15 pin

ISO  
12098  
13 pin

13-3040-004

13-3140-004



13-3070-004

13-3170-004



ISO  
12098  
15 pin

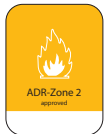
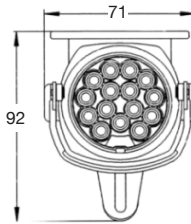
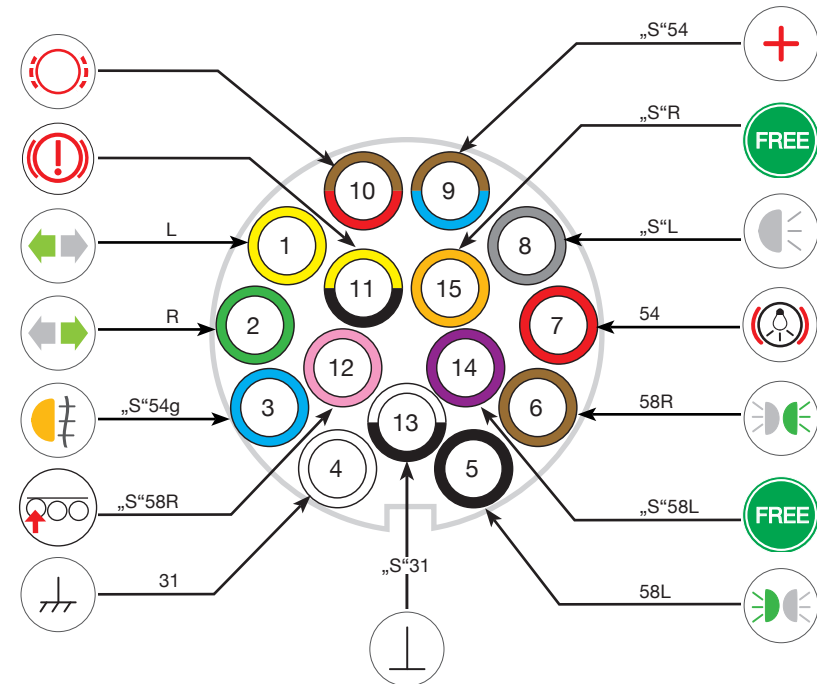
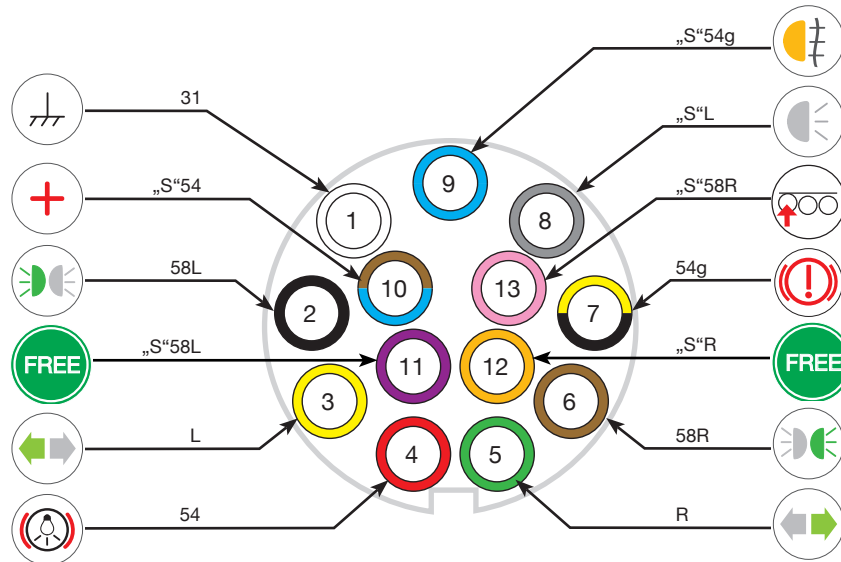
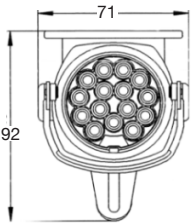



ISO 1724 7 pin

ISO 11446 13 pin, ISO 11446 8 pin

ISO 1724  
7 pin

13-3000-054

13-3103-004

13-3137-094

13-3037-004



ISO 11446  
13 pin

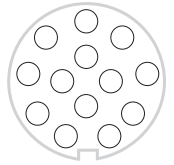
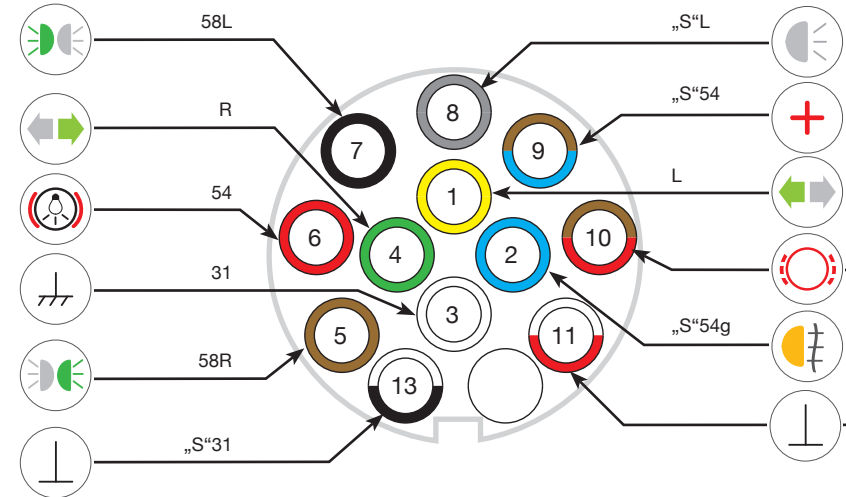
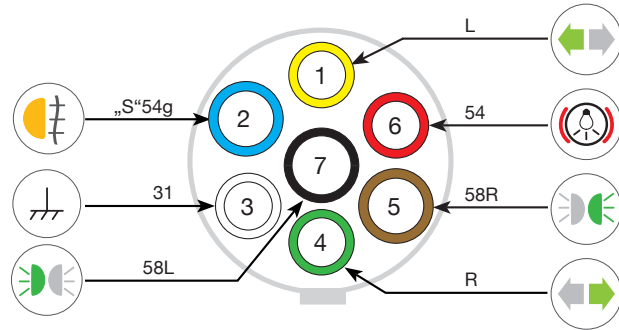

ISO 11446  
8 pin

DIN 9680 3 pin

DIN 9680  
3 pin

13-3093-504



13-3193-504

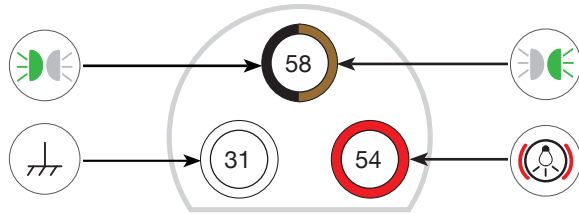

VBG 14 pin

VBG  
14 pin

13-3050-001



13-3150-001

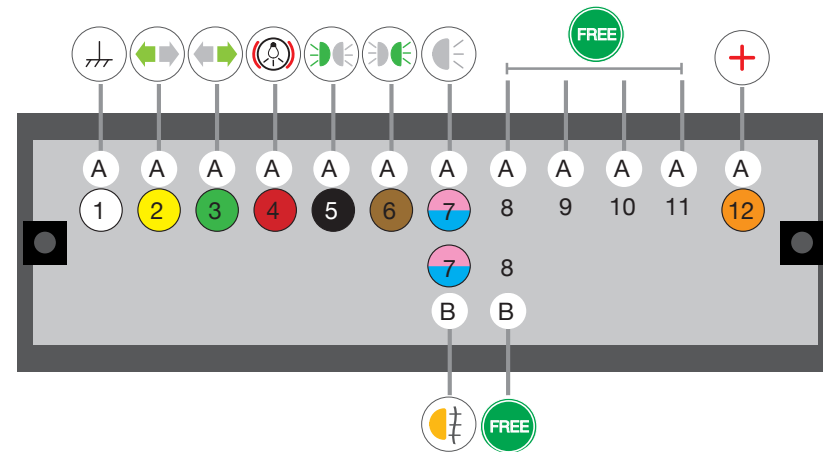

# THE ART OF LIGHTS

## ASPÖCK SYSTEMS GMBH

Enzing 4 | 4722 Peuerbach | AUSTRIA

Phone: +43 72 76 / 26 70-0

E-Mail: office@aspoeck.com | www.aspoeck.com



Part N.: 10-0350-027  
Printing errors, technical changes,  
as well as picture changes reserved.  
Picture credits: All illustrations and photographs  
© Aspöck Systems GmbH 01/2020

MOUNTING SERVICE CONNECTORS  
BOOK SERVICE BOOK

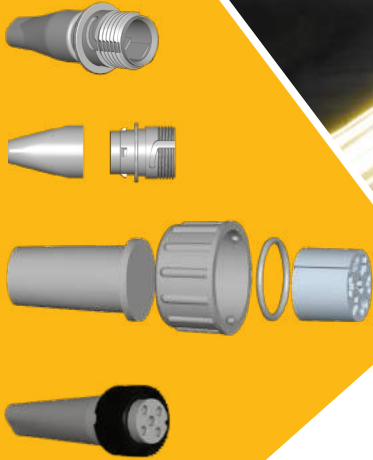

created: LAN checked: TW approved: BM AAW 130.01  
Date: 22.02.2018 Date: 01.04.2020 Date: 01.04.2020 Version: 04